

Record Drawings have been reviewed by the Project Engineer, and represent to the best of my knowledge, the project as constructed.
 PE *Kj Roheim* Date 3-23-15

DO NOT SCALE FROM THESE DRAWINGS USE DIMENSIONS

PATH: Q:\ISGY169304\ENIC3D 69304\SOURCE DWG51A2 - LAYOUT PLAN.DWG

FAGNANT, THOMAS D (DOT)
 TAB: A2 Wednesday, April 11, 2012 8:31:54 AM

ADDENDUM NUMBER

ATTACHMENT NUMBER

RECORD OF REVISIONS

No.	DATE	DESCRIPTION

PLAN LEGEND

CHECKED BY: C. TRIPP

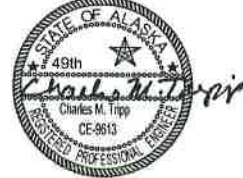

DESIGNED BY: T. FAGNANT

DRAWN BY: T. FAGNANT

STATE OF ALASKA
 DEPARTMENT OF TRANSPORTATION
 & PUBLIC FACILITIES
 SOUTHEAST REGION

SKAGWAY PEDESTRIAN
 IMPROVEMENTS

LAYOUT PLAN

PROJECT DESIGNATION

69304

STATE	YEAR
ALASKA	2012
SHEET NUMBER	TOTAL SHEETS
A2	21

ADDENDUM NUMBER

ATTACHMENT NUMBER

RECORD OF REVISIONS

No.	DATE	DESCRIPTION

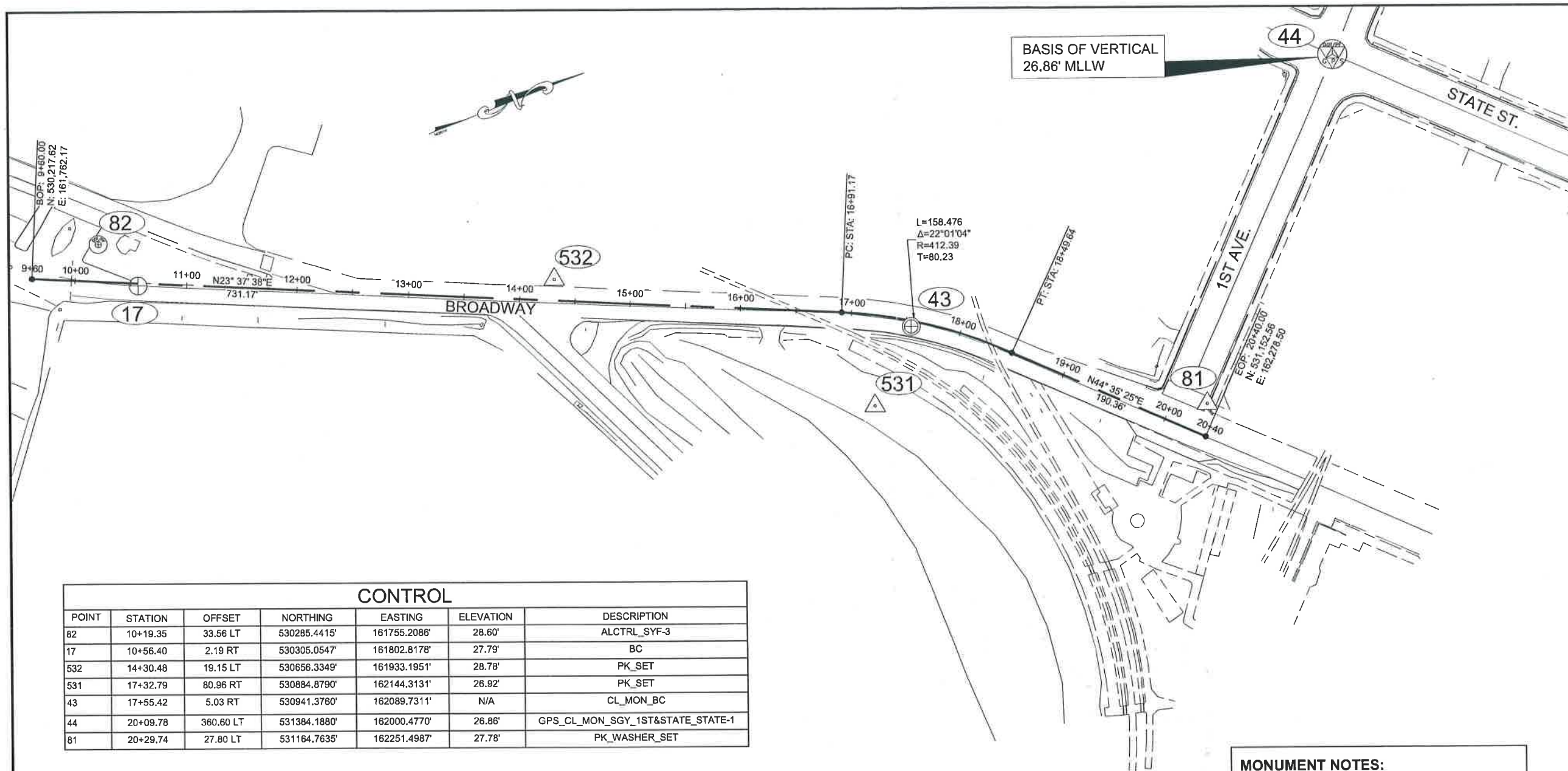

CONTROL

POINT	STATION	OFFSET	NORTHING	EASTING	ELEVATION	DESCRIPTION
82	10+19.35	33.56 LT	530285.4415'	161755.2086'	28.60'	ALCTRL_SYF-3
17	10+56.40	2.19 RT	530305.0547'	161802.8178'	27.79'	BC
532	14+30.48	19.15 LT	530656.3349'	161933.1951'	28.78'	PK_SET
531	17+32.79	80.96 RT	530884.8790'	162144.3131'	26.92'	PK_SET
43	17+55.42	5.03 RT	530941.3760'	162089.7311'	N/A	CL_MON_BC
44	20+09.78	360.60 LT	531384.1880'	162000.4770'	26.88'	GPS_CL_MON_SGY_1ST&STATE_STATE-1
81	20+29.74	27.80 LT	531164.7635'	162251.4987'	27.78'	PK_WASHER_SET

Record Drawings have been reviewed by the Project Engineer, and represent to the best of my knowledge, the project as constructed.
PE *K.J. Norheim* Date 3-23-15

MONUMENT NOTES:

1. If any pair of control points disagrees from published value by more than 1:10,000 horizontally or vertically then a third network point must be tied to ascertain which point is in error or has been disturbed.
2. Whether listed or not, all monuments, property markers, or accessories that will be disturbed or buried shall be referenced prior to being disturbed, and re-established in their original position and a record of monument form in accordance with A.S.34.65.040 shall be submitted to the construction engineer for review prior to recording. Coordinate values listed are for informational purposes and should be used to reset monuments only as a last resort.

PLAN LEGEND

CHECKED BY: R. DAVIS



DESIGNED BY: T. REED

DRAWN BY: T. FAGNANT

STATE OF ALASKA
DEPARTMENT OF TRANSPORTATION
& PUBLIC FACILITIES
SOUTHEAST REGION

SKAGWAY PEDESTRIAN
IMPROVEMENTS

SURVEY CONTROL

PROJECT DESIGNATION

69304

STATE	YEAR
ALASKA	2012

SHEET NUMBER	TOTAL SHEETS
A3	21

DO NOT SCALE FROM THESE DRAWINGS USE DIMENSIONS

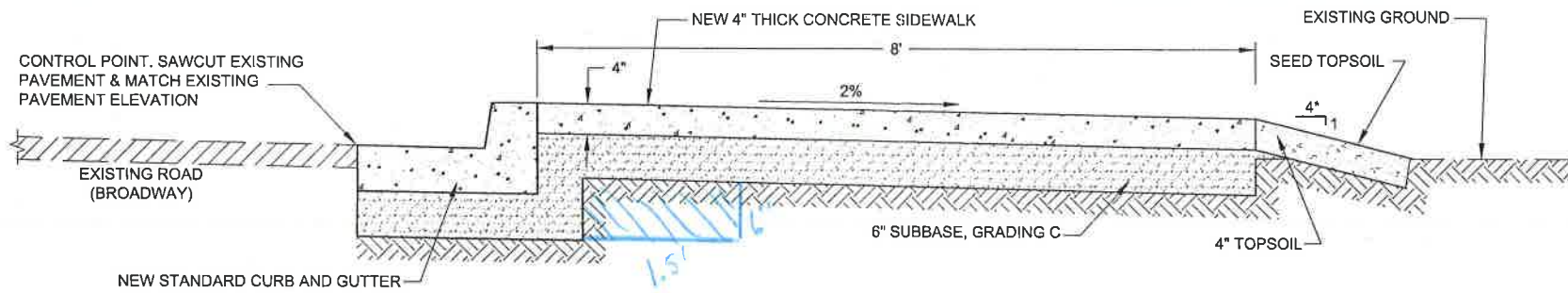

1 BROADWAY TYPICAL SECTION

STATION 11+75 TO STATION 13+60
 STATION 15+16 TO STATION 16+78
 STATION 17+37 TO STATION 18+37

*USE A 1.5:1 SLOPE AT STATIONS:
 13+45 TO 13+60
 *USE A 2:1 SLOPE AT STATIONS:
 15+16 TO 16+30

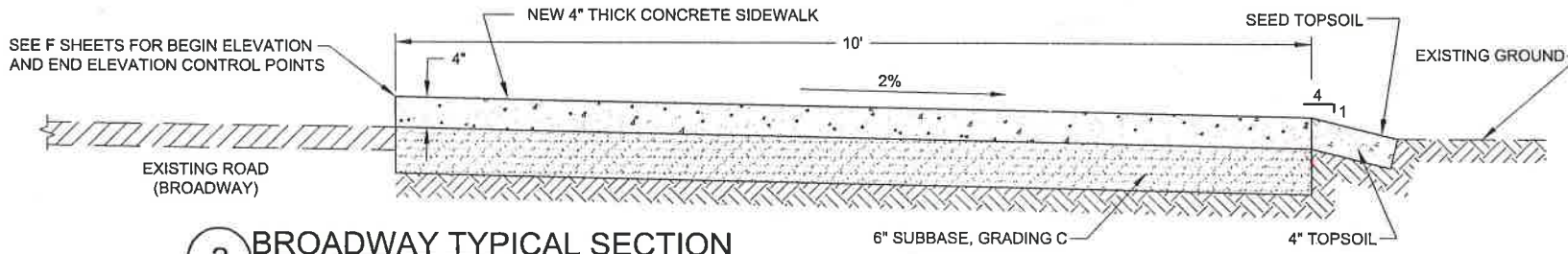

2 BROADWAY TYPICAL SECTION

STATION 16+78 TO STATION 17+03

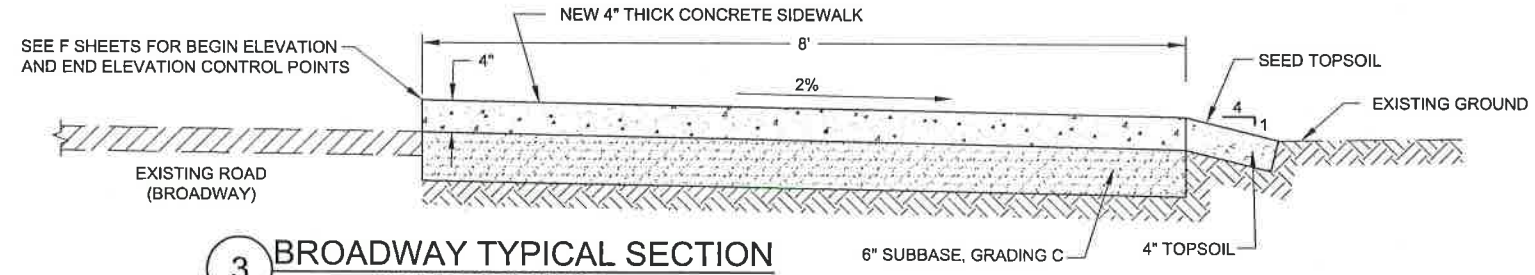

3 BROADWAY TYPICAL SECTION

STATION 18+37 TO STATION 18+68
 STATION 18+67 TO STATION 19+82

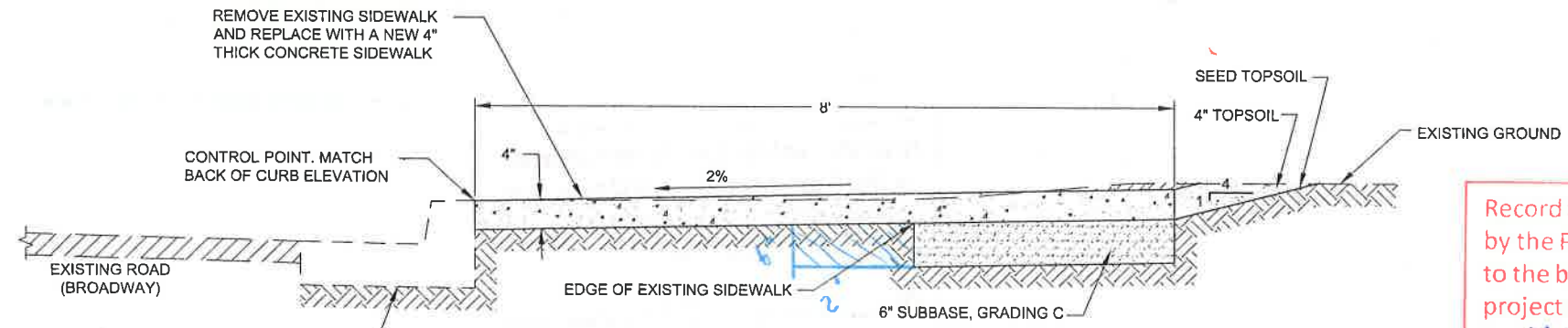

4 BROADWAY TYPICAL SECTION (ALTERNATE A)

STATION 10+40 TO STATION 11+62

Record Drawings have been reviewed by the Project Engineer, and represent to the best of my knowledge, the project as constructed.
 PE *K.P. Mahin* Date *3-23-15*

DO NOT SCALE FROM THESE DRAWINGS USE DIMENSIONS

PATH:Q:\SGY\69304\ENIC3D 69304\SOURCE DWGS\B - TYP.S.DWG

FAGNANT, THOMAS D (DOT)
 TAB: B1 Monday, May 07, 2012 10:40:25 AM

ADDENDUM NUMBER

ATTACHMENT NUMBER

RECORD OF REVISIONS

No.	DATE	DESCRIPTION

TYPICAL SECTIONS

PLAN LEGEND

CHECKED BY: C. TRIPP

DESIGNED BY: T. FAGNANT
 DRAWN BY: T. FAGNANT

STATE OF ALASKA
 DEPARTMENT OF TRANSPORTATION & PUBLIC FACILITIES
 SOUTHEAST REGION

SKAGWAY PEDESTRIAN IMPROVEMENTS

TYPICAL SECTIONS

PROJECT DESIGNATION

69304

STATE	YEAR
ALASKA	2012
SHEET NUMBER	TOTAL SHEETS
B1	21

No.	DATE	DESCRIPTION

ESTIMATE OF QUANTITIES

ESTIMATE OF QUANTITIES			
ITEM NO.	PAY ITEM	PAY UNIT	PLAN QUANTITY
202(1)	REMOVAL OF STRUCTURES AND OBSTRUCTIONS	LUMP SUM	ALL REQ'D
203(19)	UNCLASSIFIED EXCAVATION	LUMP SUM	ALL REQ'D
204(1)	STRUCTURE EXCAVATION	CUBIC YARD	10
304(1)	SUBBASE, GRADING C	TON	488
603(22)-4	4 INCH TRENCH DRAIN	LINEAR FOOT	51 48.5
603(22)-6	6 INCH TRENCH DRAIN	LINEAR FOOT	80
604(1)	STORM SEWER MANHOLE	EACH	1
608(1A)	CONCRETE SIDEWALK, 4 INCHES THICK	SQUARE YARD	680
608(6)	CURB RAMP	EACH	5
609(2)	CURB AND GUTTER, TYPE 1	LINEAR FOOT	470 447
615(1)	STANDARD SIGN	SQUARE FOOT	51
615(2)	REMOVE AND RELOCATE EXISTING SIGN	EACH	14
618(2)	SEEDING	POUND	12
620(1)	TOPSOIL	SQUARE YARD	160 164
621(2)	SHRUB	EACH	134 135
638(1)	FIBER ROLL	LINEAR FOOT	350 300
640(1)	MOBILIZATION AND DEMOBILIZATION	LUMP SUM	ALL REQ'D
640(4)	WORKER MEALS AND LODGING	LUMP SUM	ALL REQ'D
641(1)	EROSION, SEDIMENT AND POLLUTION CONTROL ADMINISTRATION	LUMP SUM	ALL REQ'D
641(2)	TEMPORARY EROSION, SEDIMENT AND POLLUTION CONTROL	CONTINGENT SUM	ALL REQ'D
642(1)	CONSTRUCTION SURVEYING	LUMP SUM	ALL REQ'D
643(2)	TRAFFIC MAINTENANCE	LUMP SUM	ALL REQ'D
643(3)	PERMANENT CONSTRUCTION SIGNS	LUMP SUM	ALL REQ'D
643(15)	FLAGGING	CONTINGENT SUM	ALL REQ'D
643(23)	TRAFFIC PRICE ADJUSTMENT	CONTINGENT SUM	ALL REQ'D
643(25)	TRAFFIC CONTROL	CONTINGENT SUM	ALL REQ'D
644(1)	FIELD OFFICE	LUMP SUM	ALL REQ'D
644(6)	VEHICLES	LUMP SUM	ALL REQ'D
650(1)	ALUMINUM INTERPRETIVE SIGN FRAME AND FOOTING	EACH	4
650(2)	WOOD INTERPRETIVE SIGN FRAMES AND FOOTINGS	LUMP SUM	1
650(3)-12	CIRCULAR CONCRETE BENCH, 12'-0" DIAMETER	EACH	1
650(3)-14	CIRCULAR CONCRETE BENCH, 14'-4" DIAMETER	EACH	1
670(1)	PAINTED TRAFFIC MARKINGS	LUMP SUM	ALL REQ'D
ADDITIVE ALTERNATE A			
202(1).A	REMOVAL OF STRUCTURES AND OBSTRUCTIONS	LUMP SUM	ALL REQ'D
202(3).A	REMOVAL OF SIDEWALK	SQUARE YARD	74
202(9).A	REMOVAL OF CURB AND GUTTER	LINEAR FOOT	20 72
203(19).A	UNCLASSIFIED EXCAVATION	LUMP SUM	ALL REQ'D
304(1).A	SUBBASE, GRADING C	TON	6
608(1A).A	CONCRETE SIDEWALK, 4 INCHES THICK	SQUARE YARD	115
608(6).A	CURB RAMP	EACH	3
609(2).A	CURB AND GUTTER, TYPE 1	LINEAR FOOT	20 26
615(2).A	REMOVE AND RELOCATE EXISTING SIGN	EACH	2
618(2).A	SEEDING	POUND	3
620(1).A	TOPSOIL	SQUARE YARD	8 40
301(5)	AGGREGATE BASE COURSE, Grading C	CYVM	300 CO 1
301(5).A	AGGREGATE BASE COURSE, Grading C	CYVM	30 CO 1
301(6)	MINOR GRADE Adjustment	LS	ALL REQ'D CO 3
501(9)	CONCRETE Price Reduction	LS	ALL REQ'D CO 3

BASIS OF ESTIMATE		
ITEM	DESCRIPTION	QUANTITY
202(1)	REMOVAL OF STRUCTURES AND OBSTRUCTIONS	SEE D-1, 202(1) REMOVAL OF STRUCTURES AND OBSTRUCTIONS SUMMARY
203(19)	UNCLASSIFIED EXCAVATION	120 C.Y.
304(1)	SUBBASE, GRADING C	QUANTITY BASED ON 1.95 TONS PER CUBIC YARD
670(1)	PAINTED TRAFFIC MARKINGS	440 S.F.
ADDITIVE ALTERNATE A		
202(1).A	REMOVAL OF STRUCTURES AND OBSTRUCTIONS	SEE D-1, 202(1).A REMOVAL OF STRUCTURES AND OBSTRUCTIONS SUMMARY
203(19).A	UNCLASSIFIED EXCAVATION	30 C.Y.

Record Drawings have been reviewed by the Project Engineer, and represent to the best of my knowledge, the project as constructed.
PE K.J. Norheim Date 3-23-15

PLAN LEGEND

CHECKED BY: C. TRIPP



DESIGNED BY: T. FAGNANT

DRAWN BY: T. FAGNANT

STATE OF ALASKA
DEPARTMENT OF TRANSPORTATION & PUBLIC FACILITIES
SOUTHEAST REGION

SKAGWAY PEDESTRIAN IMPROVEMENTS

ESTIMATE OF QUANTITIES

PROJECT DESIGNATION

69304

STATE	YEAR
ALASKA	2012

SHEET NUMBER	TOTAL SHEETS
C1	21

PATH: Q:\SGY\69304\ENVC3D 69304\SOURCE
DWGSD - MISC. SUMM.DWG
FAGNANT, THOMAS D (DOT)
TAB: D1 Wednesday, April 11, 2012 11:20:22 AM
ADDENDUM NUMBER
ATTACHMENT NUMBER
RECORD OF REVISIONS
No. DATE DESCRIPTION

REMOVAL OF STRUCTURES AND OBSTRUCTIONS SUMMARY	
STATION, OFFSET	DESCRIPTION
202(1) REMOVAL OF STRUCTURES AND OBSTRUCTIONS	
14+60, 27' RT	REMOVE EXISTING LOG
13+72, 28' RT	REMOVE 12"Ø CPP END
11+75 TO 13+60	SAWCUT AND REMOVE ASPHALT EDGE
15+16 TO 16+78	SAWCUT AND REMOVE ASPHALT EDGE
17+37 TO 18+37	SAWCUT AND REMOVE ASPHALT EDGE
12+80, 25' LT	REMOVE 2 SIGNS ON SINGLE POST
202(1).A REMOVAL OF STRUCTURES AND OBSTRUCTIONS	
11+69, 10' LT	RELOCATE EXISTING BENCH

TRENCH DRAIN					
STATION	LENGTH	STATION	LENGTH	STATION	LENGTH
603(22)-4 TRENCH DRAIN					
15+85	16'	19+20	8'	19+38	19'
19+54	8'				
603(22)-6 TRENCH DRAIN					
12+21	8'	12+68	8'	13+14	8'
13+56	8'	15+18	8'	15+64	8'
16+52	8'	17+43	8'	17+89	8'
18+34	8'				

STRUCTURES SUMMARY				
NAME	STATION	OFFSET	CONTROL ELEV.	INLET TYPE
604(1) - STORM SEWER MANHOLE				
S-1	19+44	17.0' RT	28.4	FIELD

CURB RAMP SUMMARY		
STATIONING	CURB LENGTH (L.F.)	AREA (S.Y.)
608(6) CURB RAMP		
11+64 TO 11+75	11	10
13+60 TO 13+84	25	14
14+50 TO 14+64	16	8
14+64 TO 14+72	28	5
14+99 TO 15+16	21	11
608(6).A CURB RAMP		
11+64 TO 11+69	5	3
10+24 TO 10+40	24	5
11+62 TO 11+72	12	10

SIGN SUMMARY						
SIGN NUMBER	DESCRIPTION	STATION	OFFSET	ACTION	ASDS CODE	AREA(S.F.)
615(1) STANDARD SIGN						
3	PEDESTRIAN CROSSING	11+62	25' RT	NEW SIGN AND POST	W11-2	9
4	LEFT ARROW	11+62	28' RT	NEW SIGN, MOUNT BELOW SIGN #3	W16-7P	3.75
7	PEDESTRIAN CROSSING	11+75	35' LT	NEW SIGN AND POST	W11-2	9
8	LEFT ARROW	11+75	35' LT	NEW SIGN, MOUNT BELOW SIGN #7	W16-7P	3.75
12	PEDESTRIAN CROSSING	13+59	28' RT	NEW SIGN AND POST	W11-2	9
13	LEFT ARROW	13+59	28' RT	NEW SIGN, MOUNT BELOW SIGN #12	W16-7P	3.75
16	PEDESTRIAN CROSSING	15+02	64' RT	NEW SIGN AND POST	W11-2	9
17	LEFT ARROW	15+02	64' RT	NEW SIGN, MOUNT BELOW SIGN #16	W16-7P	3.75
615(2) REMOVE AND RELOCATE SIGN						
5	BACK TRACK RV PARK	11+66	28' RT	RELOCATE SIGN AND POST TO 11+62, 28' RT		
6	PULLEN CREEK RV PARK	11+66	28' RT	RELOCATE SIGN TO 11+66, 28' RT		
9	9TH & MAIN, MILE ZERO B&B	12+80	25' RT	RELOCATE SIGN AND POST TO 12+80, 28' RT		
10	PEDESTRIAN CROSSING	12+80	25' LT	REMOVE SIGN AND POST. [PAID UNDER 202(1)]		
11	PED XING	12+80	25' LT	REMOVE SIGN. [PAID UNDER 202(1)]		
14	RAILROAD DOCK & SMALL BOAT HARBOR	14+61	24' RT	RELOCATE SIGN AND POST TO 14+61, 28' RT		
15	RAILROAD DOCK & SMALL BOAT HARBOR	14+61	24' RT	RELOCATE SIGN AND POST TO 14+61, 28' RT		
18	STOP	15+11	24' RT	RELOCATE SIGN AND POST TO 15+11, 26' RT	R1-1	
19	SPEED LIMIT 25	15+16	23' RT	RELOCATE SIGN AND POST TO 15+16, 26' RT	R2-1	
20	NO LITTER	15+65	20' RT	REMOVE SIGN AND POST TO 15+55, 26' RT		
21	RAILROAD CROSSING	16+39	23' RT	RELOCATE SIGN TO 16+39, 28' RT	R15-1	
22	2 TRACKS	16+39	23' RT	RELOCATE SIGN TO 16+39, 28' RT		
23	RAILROAD CROSSING	18+34	22' RT	RELOCATE SIGN AND POST TO 18+34, 30' RT		
24	LEFT ARROW, WHITEHORSE	18+34	29' RT	RELOCATE SIGN AND POST TO 18+34, 35' RT		
25	SKAGWAY CENTENNIAL PARK	18+81	28' RT	RELOCATE SIGN TO 18+71, 21' RT		
26	KLONDIKE GOLD RUSH NATIONAL HISTORIC PARK	19+47	23' RT	RELOCATE SIGN TO 19+47, 18' RT		
615(2).A REMOVE AND RELOCATE SIGN						
1	STOP	10+30	52' LT	RELOCATE SIGN TO 10+30, 50' LT	R1-1	
2	NO RIGHT TURN	10+35	49' LT	RELOCATE SIGN TO 10+35, 47' LT	R3-1	

650(40D).A INTERPRETIVE SIGN, TYPE D			
DESCRIPTION	STATION	OFFSET	ACTION
INTERPRETIVE SIGN 1	15+71	44' RT	NEW FRAME AND FOOTING
INTERPRETIVE SIGN 2	15+78	57' RT	NEW FRAME AND FOOTING
INTERPRETIVE SIGN 3	15+92	57' RT	NEW FRAME AND FOOTING
INTERPRETIVE SIGN 4	15+99	44' RT	NEW FRAME AND FOOTING
INTERPRETIVE SIGN 5	19+52	52' RT	NEW FRAME AND FOOTING
INTERPRETIVE SIGN 6	19+53	45' RT	NEW FRAME AND FOOTING
INTERPRETIVE SIGN 7	19+53	49' RT	NEW FRAME AND FOOTING

NOTE:
1. VERTICAL CONTROL IS SET BY EXISTING GROUND FOR STORM SEWER MANHOLE.
2. RAMPS ON 608(6) ARE ASSUMED TO BE A LENGTH OF 6'.
3. INTERPRETIVE PANELS FOR INTERPRETIVE SIGNS TO BE PROVIDED BY OTHERS.

Record Drawings have been reviewed by the Project Engineer, and represent to the best of my knowledge, the project as constructed.
PE *H. N. Nishin* Date 3-23-15

DO NOT SCALE FROM THESE DRAWINGS USE DIMENSIONS

PLAN LEGEND

CHECKED BY: C. TRIPP



DESIGNED BY: T. FAGNANT

DRAWN BY: T. FAGNANT

STATE OF ALASKA
DEPARTMENT OF TRANSPORTATION
& PUBLIC FACILITIES
SOUTHEAST REGION

SKAGWAY PEDESTRIAN
IMPROVEMENTS

MISCELLANEOUS
SUMMARIES

PROJECT DESIGNATION

69304

STATE	YEAR
ALASKA	2012

SHEET NUMBER	TOTAL SHEETS
D1	21

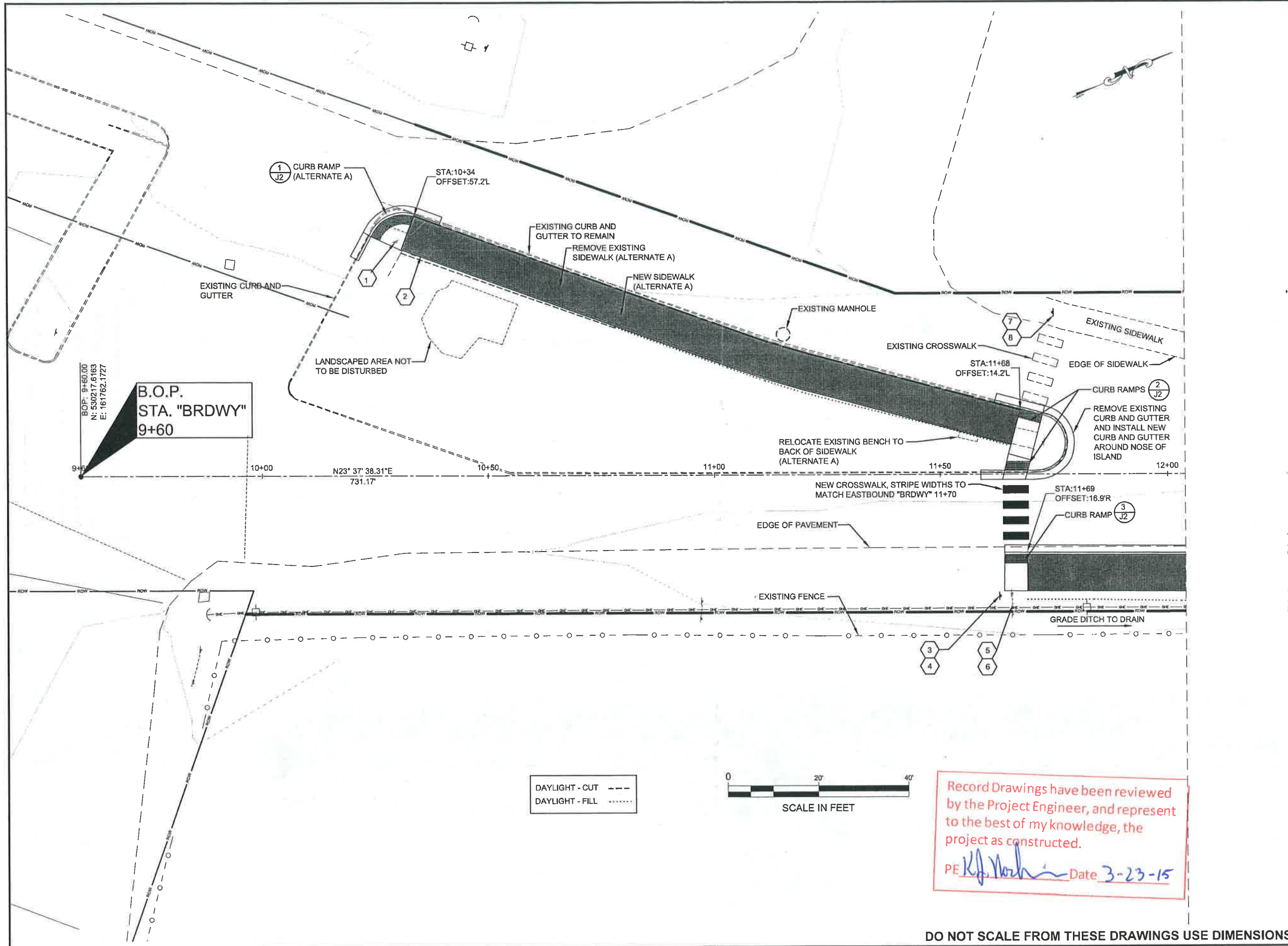

Record Drawings have been reviewed by the Project Engineer, and represent to the best of my knowledge, the project as constructed.
 PE *K.J. Nordin* Date 3-23-15

DO NOT SCALE FROM THESE DRAWINGS USE DIMENSIONS

PATH:Q:\ISGY189304\ENIC3D 69304\SOURCE DWGS\F - PLAN.DWG

FAGNANT, THOMAS D (DOT)
 TAB: F1 Wednesday, April 11, 2012 11:22:07 AM

ADDENDUM NUMBER

ATTACHMENT NUMBER

RECORD OF REVISIONS

No.	DATE	DESCRIPTION

PLAN LEGEND

CHECKED BY: C. TRIPP



DESIGNED BY: T. FAGNANT
 DRAWN BY: T. FAGNANT

STATE OF ALASKA
 DEPARTMENT OF TRANSPORTATION
 & PUBLIC FACILITIES
 SOUTHEAST REGION

SKAGWAY PEDESTRIAN
 IMPROVEMENTS

PLAN VIEW

PROJECT DESIGNATION

69304

STATE	YEAR
ALASKA	2012
SHEET NUMBER	TOTAL SHEETS
F1	21

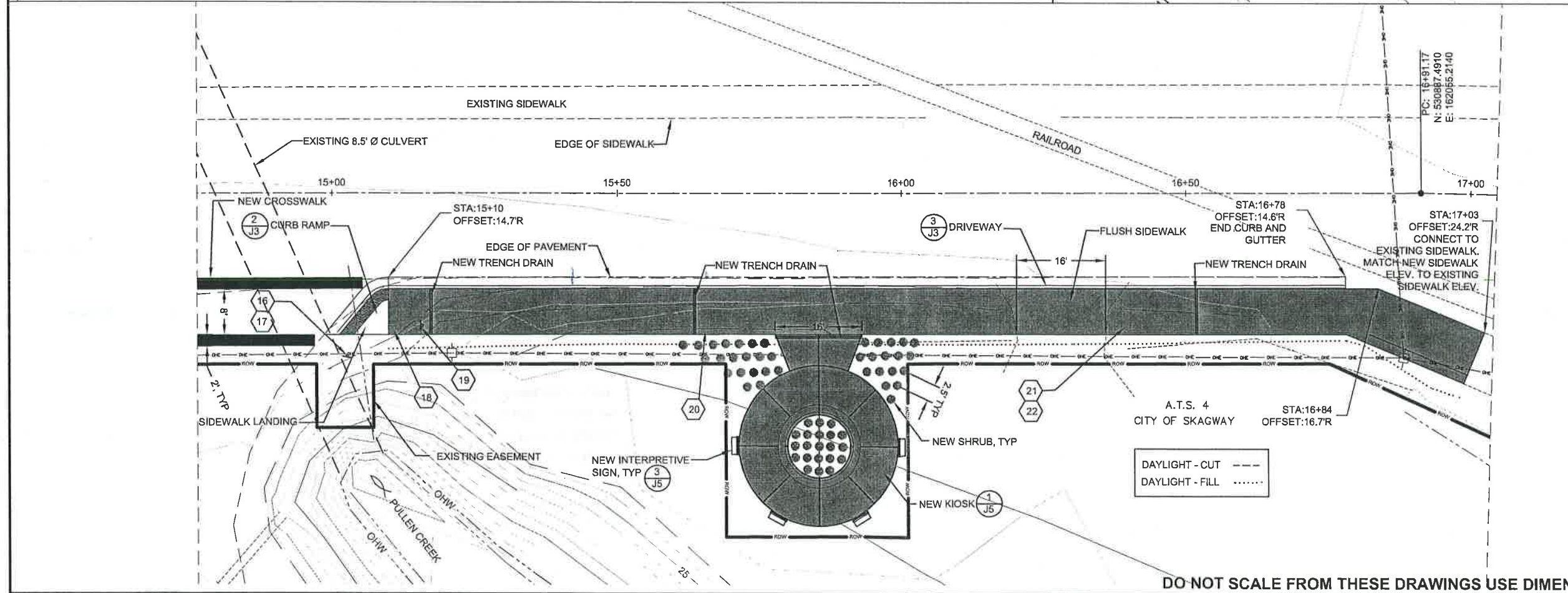
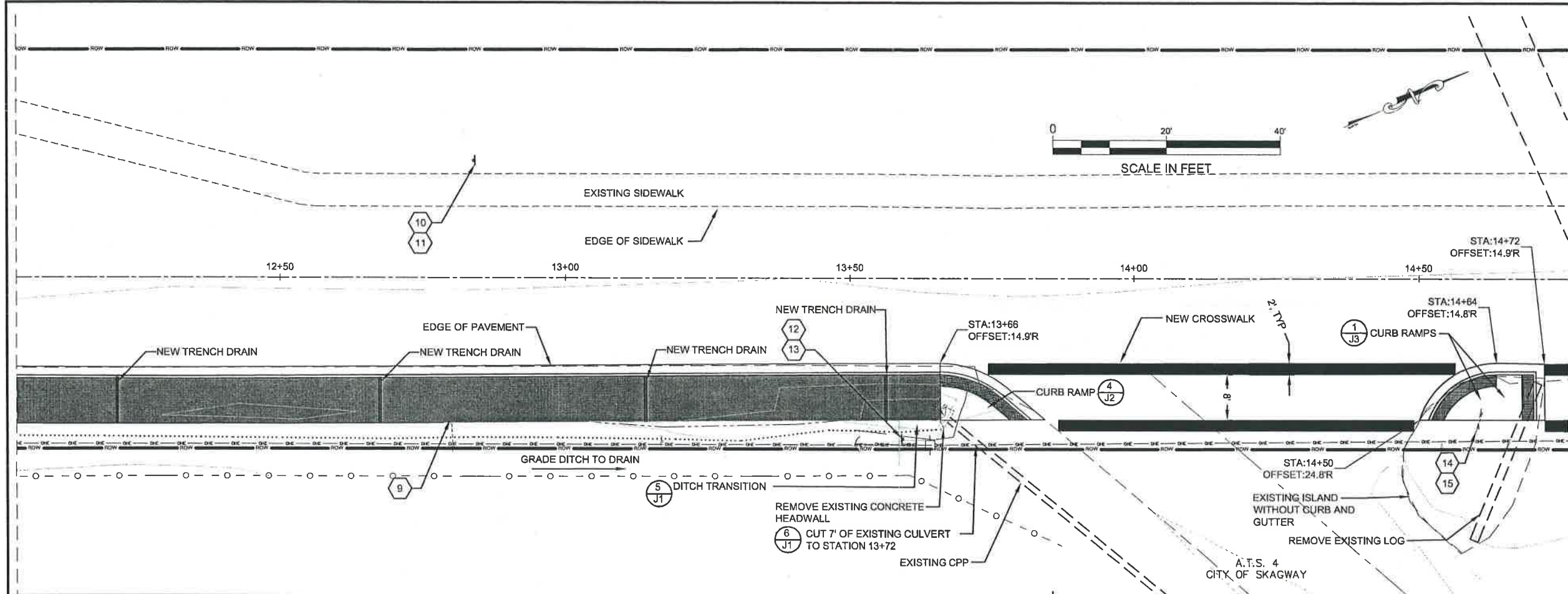

PATH:Q:\ISGY\69304\ENIC3D 69304\SOURCE DWGS\F - PLAN.DWG

FAGNANT, THOMAS D (DOT)
 TAB: F2 Wednesday, April 11, 2012 11:23:10 AM

ADDENDUM NUMBER

ATTACHMENT NUMBER

RECORD OF REVISIONS

No.	DATE	DESCRIPTION

Record Drawings have been reviewed by the Project Engineer, and represent to the best of my knowledge, the project as constructed.

PE *Charles M. Tripp* Date 3-23-15

PLAN LEGEND

CHECKED BY: C. TRIPP

DESIGNED BY: T. FAGNANT
 DRAWN BY: T. FAGNANT

STATE OF ALASKA
 DEPARTMENT OF TRANSPORTATION & PUBLIC FACILITIES
 SOUTHEAST REGION

SKAGWAY PEDESTRIAN IMPROVEMENTS

PLAN VIEW

PROJECT DESIGNATION

69304

STATE	YEAR
ALASKA	2012
SHEET NUMBER	TOTAL SHEETS
F2	21

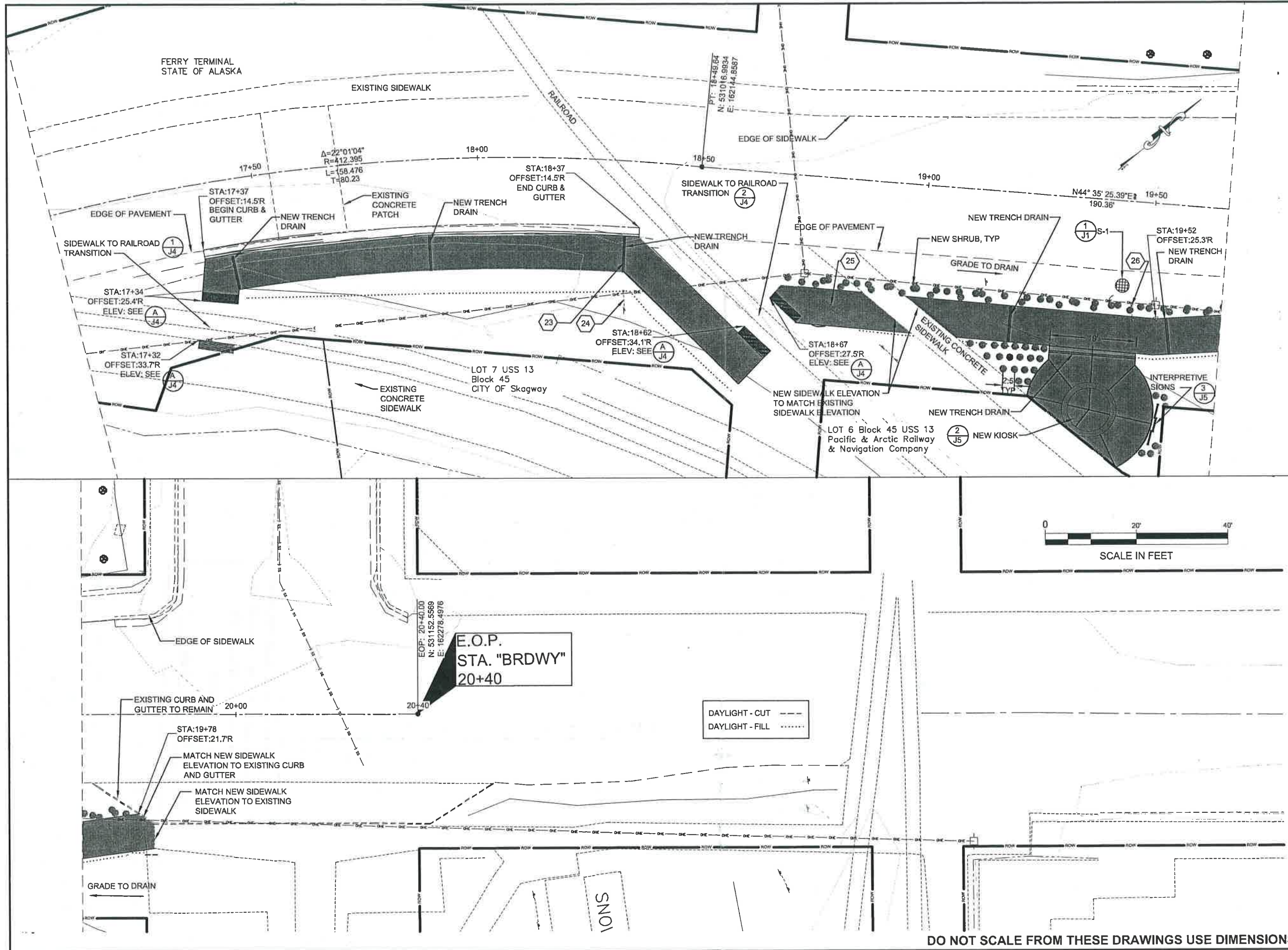

PATH: Q:\ISGY\69304\ENIC3D 69304\SOURCE DWGS\F - PLAN.DWG

FAGNANT, THOMAS D (DOT)
 TAB: F3 Wednesday, April 11, 2012 11:23:47 AM

RECORD OF REVISIONS		
No.	DATE	DESCRIPTION

Record Drawings have been reviewed by the Project Engineer, and represent to the best of my knowledge, the project as constructed.
 PE: *K.P. Nishi* Date 3-23-15

PLAN LEGEND

CHECKED BY: C. TRIPP

DESIGNED BY: T. FAGNANT
 DRAWN BY: T. FAGNANT

STATE OF ALASKA
 DEPARTMENT OF TRANSPORTATION & PUBLIC FACILITIES
 SOUTHEAST REGION

SKAGWAY PEDESTRIAN IMPROVEMENTS

PLAN VIEW

PROJECT DESIGNATION	
69304	
STATE	YEAR
ALASKA	2012
SHEET NUMBER	TOTAL SHEETS
F3	21

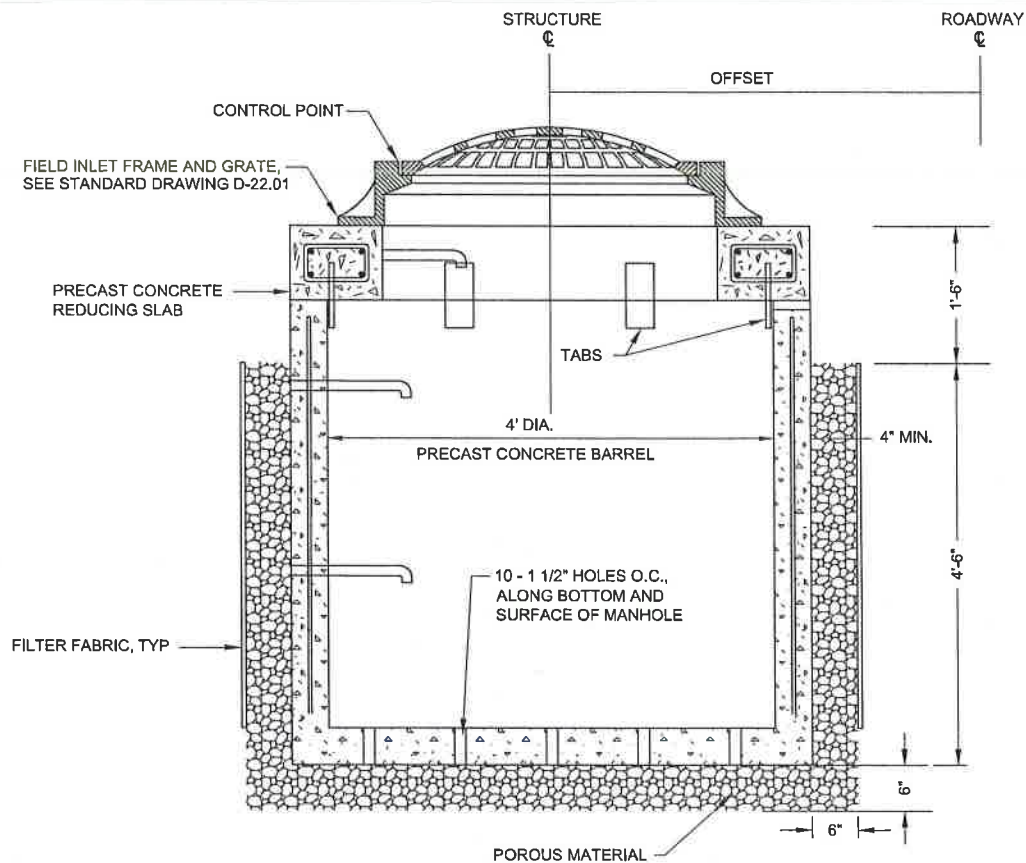

1 S-1, STORM SEWER MANHOLE, TYPE I

SEE STANDARD DRAWING D-35.00 FOR PLAN VIEW AND STORM SEWER MANHOLE DETAILS. NOTE THE BOTTOM MODIFICATIONS SHOWN IN THIS DETAIL. POROUS MATERIAL AND FILTER FABRIC ARE SUBSIDIARY TO THIS ITEM

NOTE: SEE SHEET D-1 FOR ELEVATION AND LOCATION OF STRUCTURE

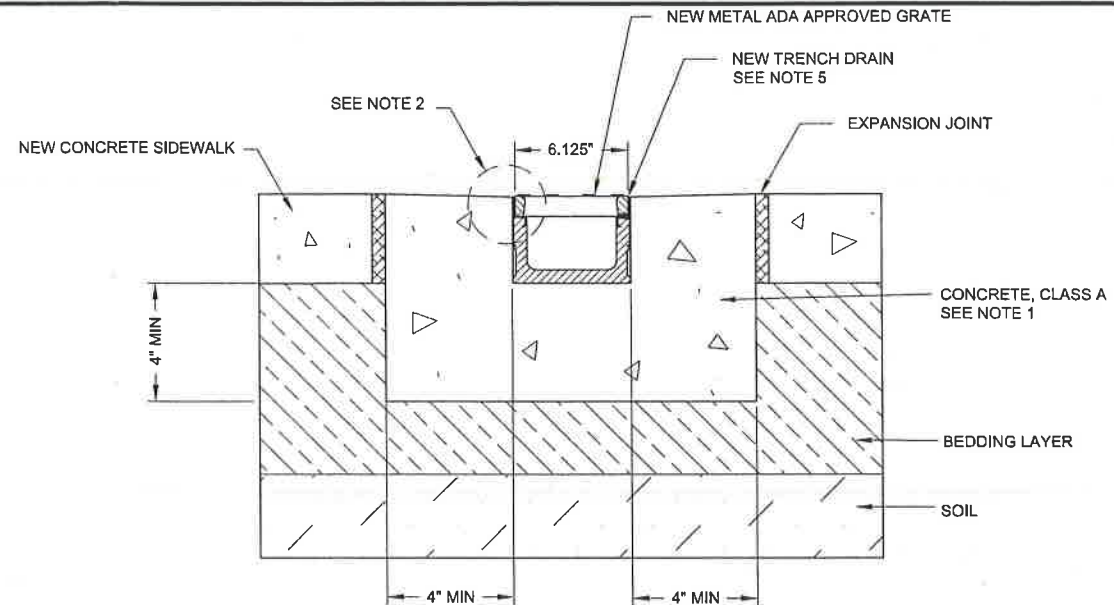

2 TRENCH DRAIN MIDDLE SECTION

NOTES:

- VIBRATE THE CONCRETE TO ELIMINATE AIR POCKETS.
- FINISH CONCRETE TO 1/8" HIGHER THAN THE TOP OF THE CHANNEL EDGE.
- INSTALL PER MANUFACTURER'S INSTRUCTIONS.
- INSTALL SIDEWALK CHANNEL PERPENDICULAR TO SIDEWALK, ENDING AT FACE OF CURB AND GUTTER OR FACE OF SIDEWALK.
- TRENCH DRAIN SHALL BE 6" DEPTH WHERE CURB AND GUTTER EXISTS, AND 4" DEPTH WHERE NO CURB AND GUTTER EXISTS.
- TRENCH DRAIN CURB OPENINGS ARE TO BE PLACED AT ENDS OF TRENCH DRAINS THAT HAVE A CURB AND GUTTER FACE.

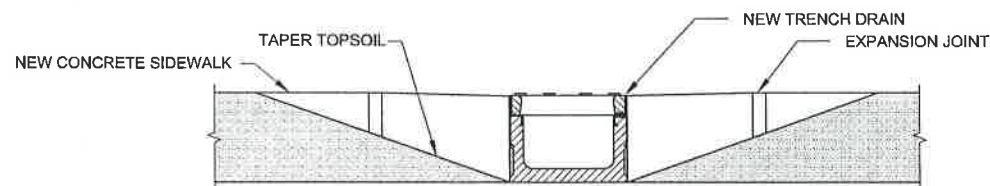

3 TRENCH DRAIN END SECTION

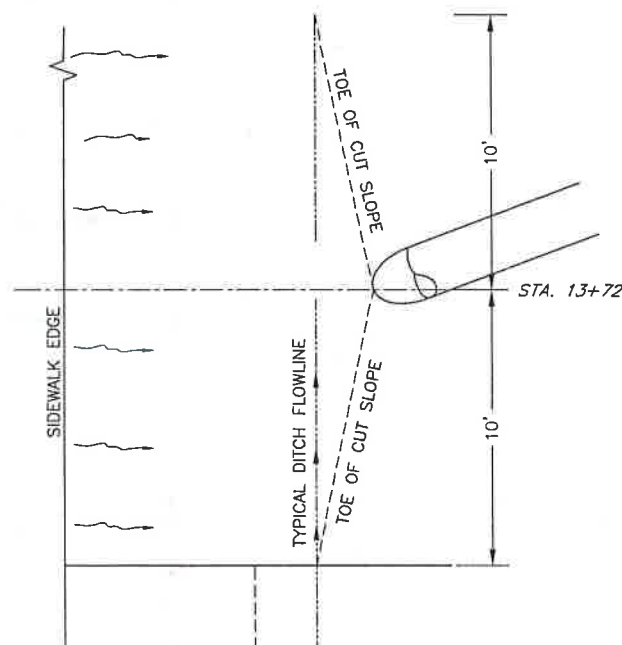

5 ALTERNATE DITCH DETAIL TRANSITION

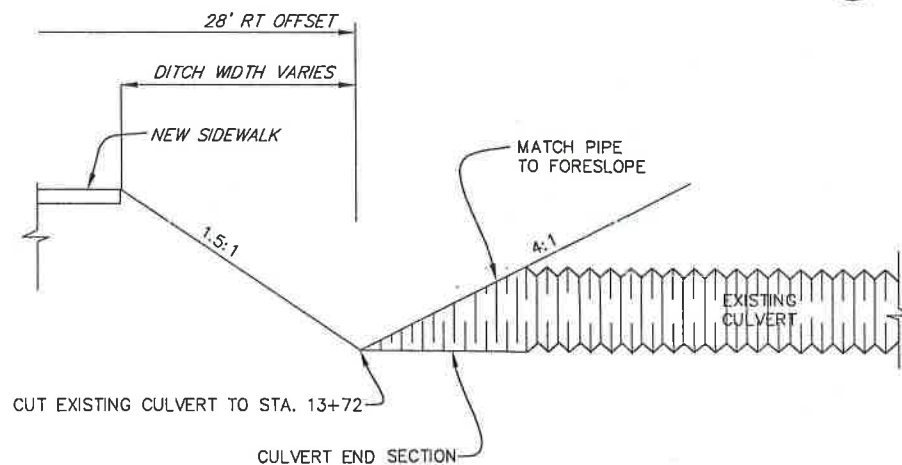

6 ALTERNATE DITCH DETAIL NTS

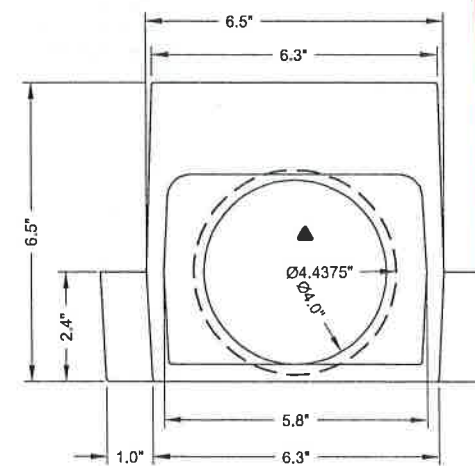

4 TRENCH DRAIN CURB OPENING

Record Drawings have been reviewed by the Project Engineer, and represent to the best of my knowledge, the project as constructed.
 PE [Signature] Date 3-23-15

PATH: Q:\SGY169304\ENIC3D 69304\SOURCE DWG\J1 - MISC DETAILS.DWG

FAGNANT, THOMAS D (DOT)
 TAB: J1 Wednesday, April 11, 2012 11:24:53 AM

ADDENDUM NUMBER

ATTACHMENT NUMBER

RECORD OF REVISIONS

No.	DATE	DESCRIPTION

PLAN LEGEND

CHECKED BY: C. TRIPP



DESIGNED BY: T. FAGNANT

DRAWN BY: J. FAGNANI

STATE OF ALASKA
 DEPARTMENT OF TRANSPORTATION
 & PUBLIC FACILITIES
 SOUTHEAST REGION

SKAGWAY PEDESTRIAN IMPROVEMENTS

DRAINAGE DETAILS

PROJECT DESIGNATION

69304

STATE	YEAR
ALASKA	2012
SHEET NUMBER	TOTAL SHEETS
J1	21

DO NOT SCALE FROM THESE DRAWINGS USE DIMENSIONS

DRAINAGE DETAILS

No.	DATE	DESCRIPTION

CURB DETAILS

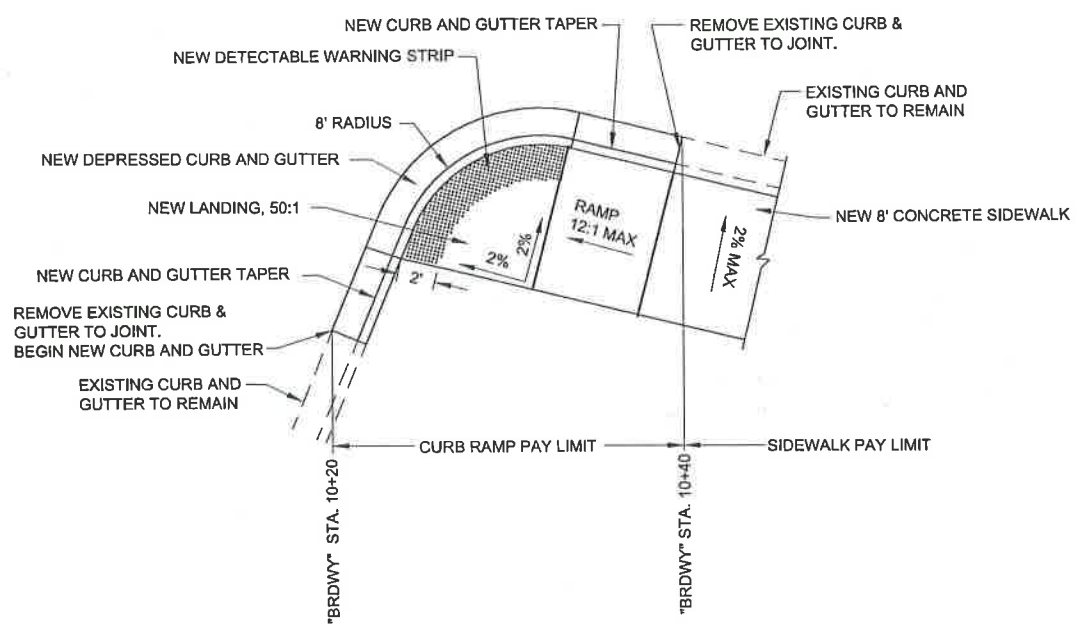

1 CURB RAMP DETAIL (ALTERNATE A)
 "BRDwy" 10+20 TO 10+40

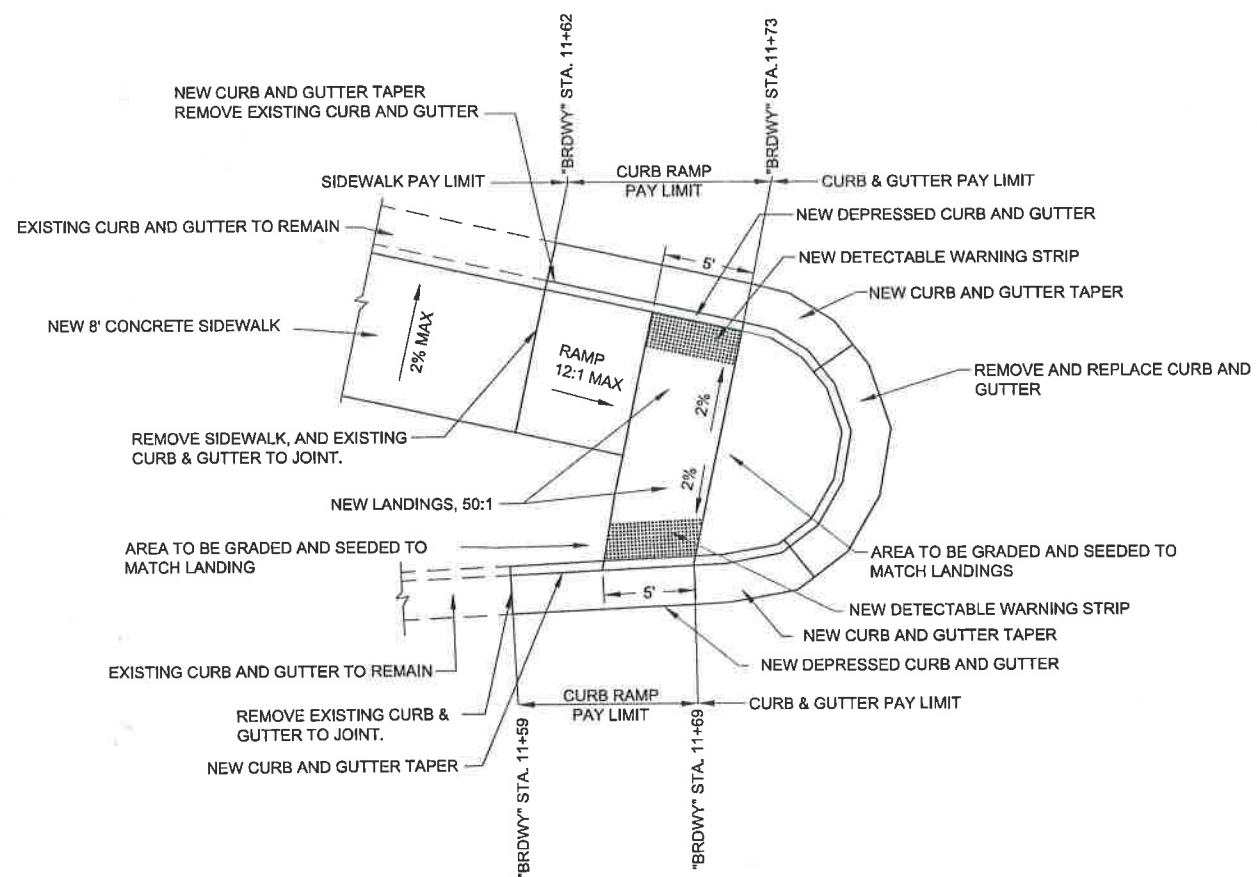

2 CURB RAMP DETAILS (ALTERNATE A)
 "BRDwy" 11+62 TO 11+73
 "BRDwy" 11+59 TO 11+69

NOTE: CURB RAMP DETAIL 2 SHOWS TWO CURB RAMP PAY ITEMS

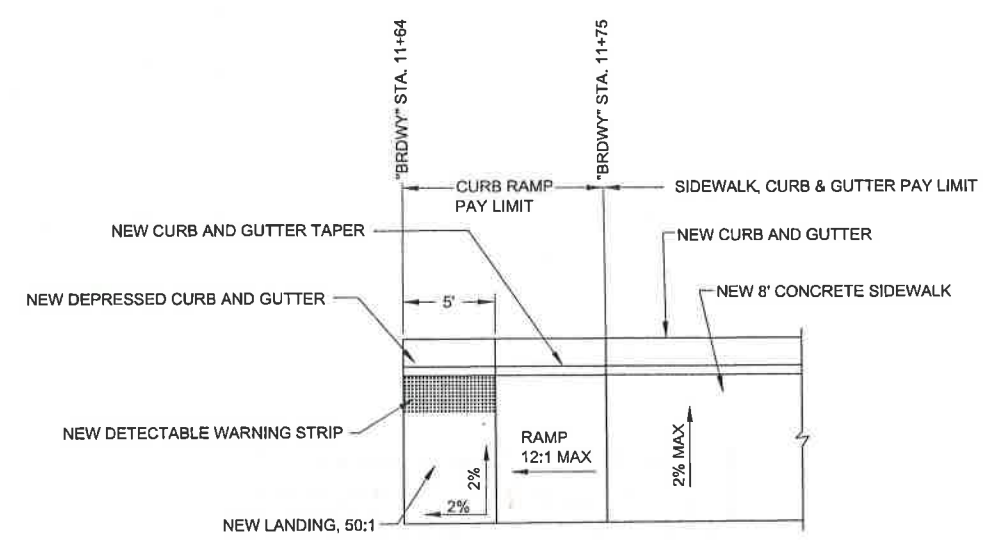

3 CURB RAMP DETAIL
 "BRDwy" 11+64 TO 11+75

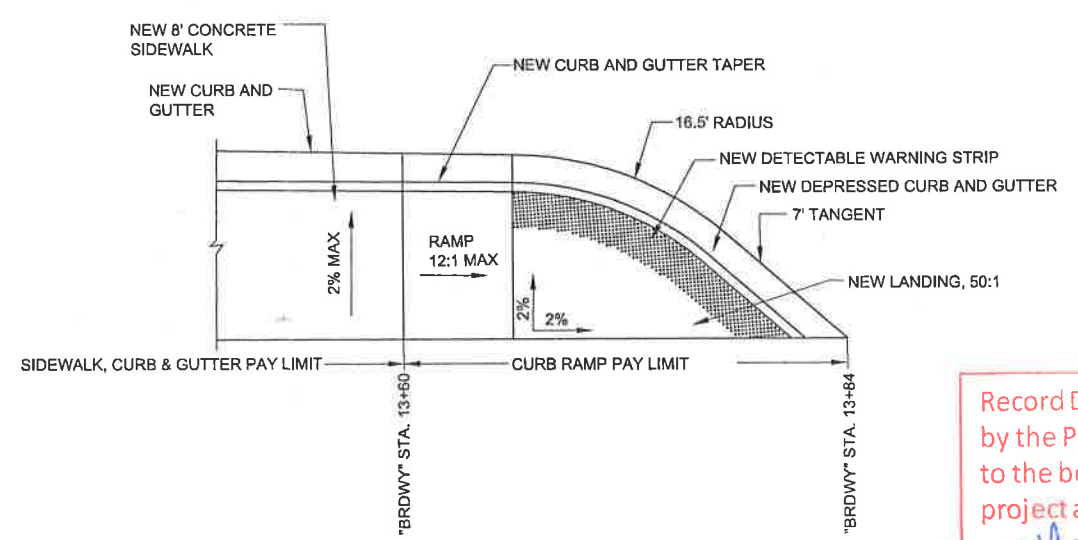

4 CURB RAMP DETAIL
 "BRDwy" 13+60 TO 13+84

Record Drawings have been reviewed by the Project Engineer, and represent to the best of my knowledge, the project as constructed.
 PE *K. J. Nohe* Date 3-23-15

PLAN LEGEND

CHECKED BY: C. TRIPP



DESIGNED BY: T. FAGNANT

DRAWN BY: T. FAGNANT

STATE OF ALASKA
 DEPARTMENT OF TRANSPORTATION & PUBLIC FACILITIES
 SOUTHEAST REGION
 SKACWAY PEDESTRIAN IMPROVEMENTS

CURB RAMP DETAILS

PROJECT DESIGNATION

69304

STATE ALASKA YEAR 2012

SHEET NUMBER TOTAL SHEETS

J2 21

DO NOT SCALE FROM THESE DRAWINGS USE DIMENSIONS

CURB RAMP DETAILS

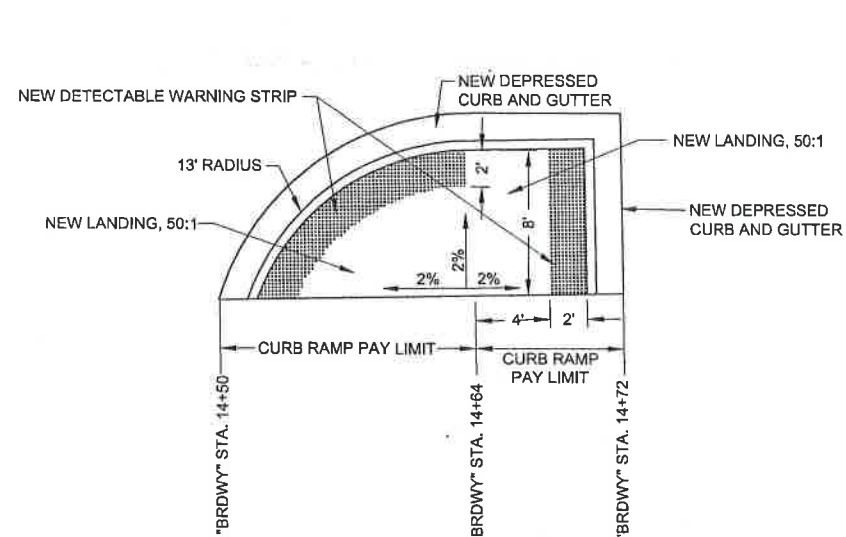

1 CURB RAMP DETAIL
 "BRD'WY" 14+50 TO 14+64
 "BRD'WY" 14+64 TO 14+72

NOTE: CURB RAMP DETAIL 1 SHOWS TWO CURB RAMP PAY ITEMS

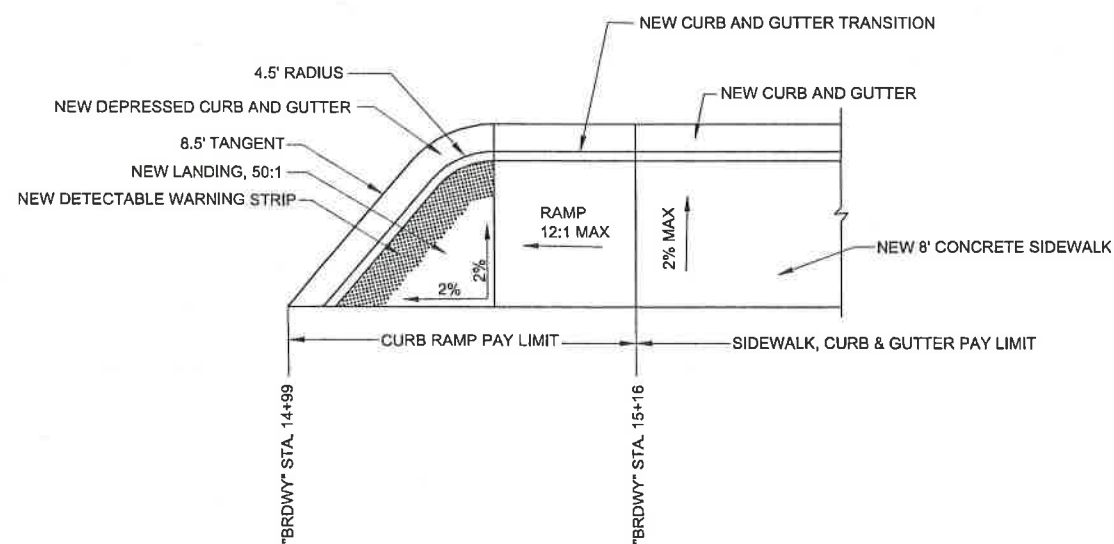

2 CURB RAMP DETAIL
 "BRD'WY" 14+99 TO 15+16

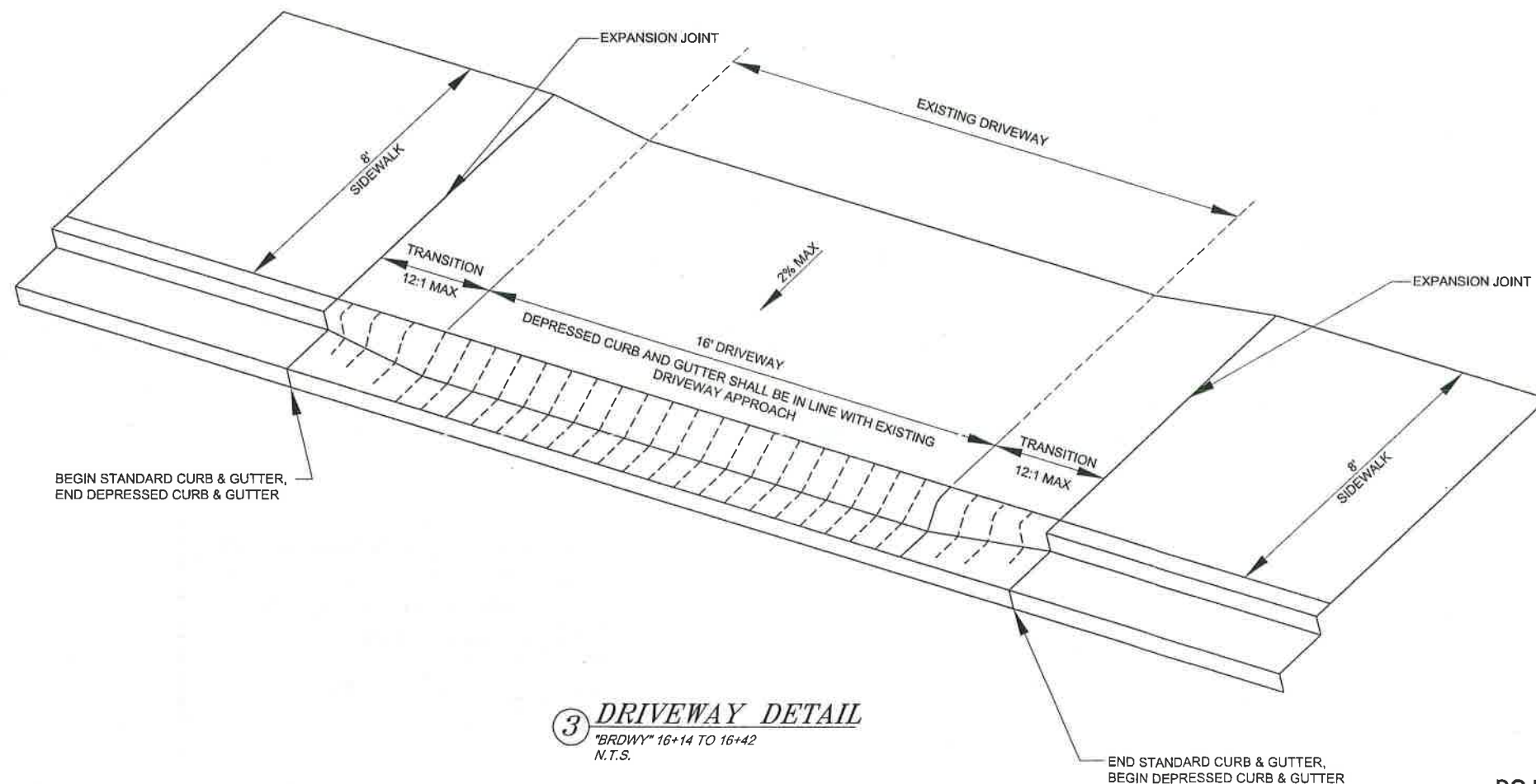

3 DRIVEWAY DETAIL
 "BRD'WY" 16+14 TO 16+42
 N.T.S.

PLAN LEGEND

CHECKED BY: C. TRIPP



DESIGNED BY: T. FAGNANT

DRAWN BY: I. FAGNANT

STATE OF ALASKA
 DEPARTMENT OF TRANSPORTATION
 & PUBLIC FACILITIES
 SOUTHEAST REGION

SKAGWAY PEDESTRIAN
 IMPROVEMENTS

CURB RAMP DETAILS

PROJECT DESIGNATION

69304

STATE YEAR
 ALASKA 2012

SHEET NUMBER TOTAL SHEETS

J3 21

Record Drawings have been reviewed by the Project Engineer, and represent to the best of my knowledge, the project as constructed.
 PE *K.A. Nelson* Date 3-23-15

DO NOT SCALE FROM THESE DRAWINGS USE DIMENSIONS

RAIL CONNECTION DETAILS

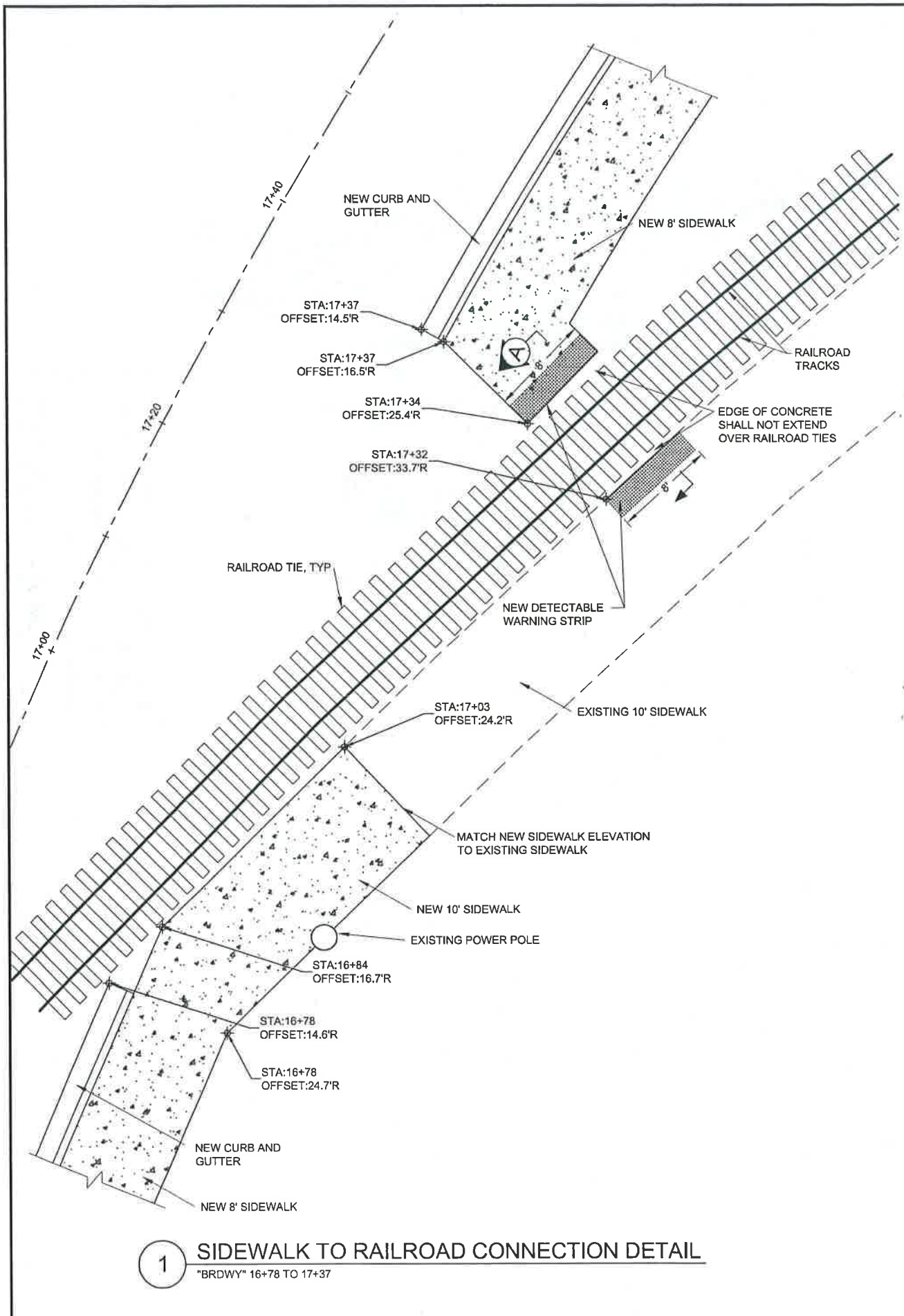

1 SIDEWALK TO RAILROAD CONNECTION DETAIL
 "BRDWY" 16+78 TO 17+37

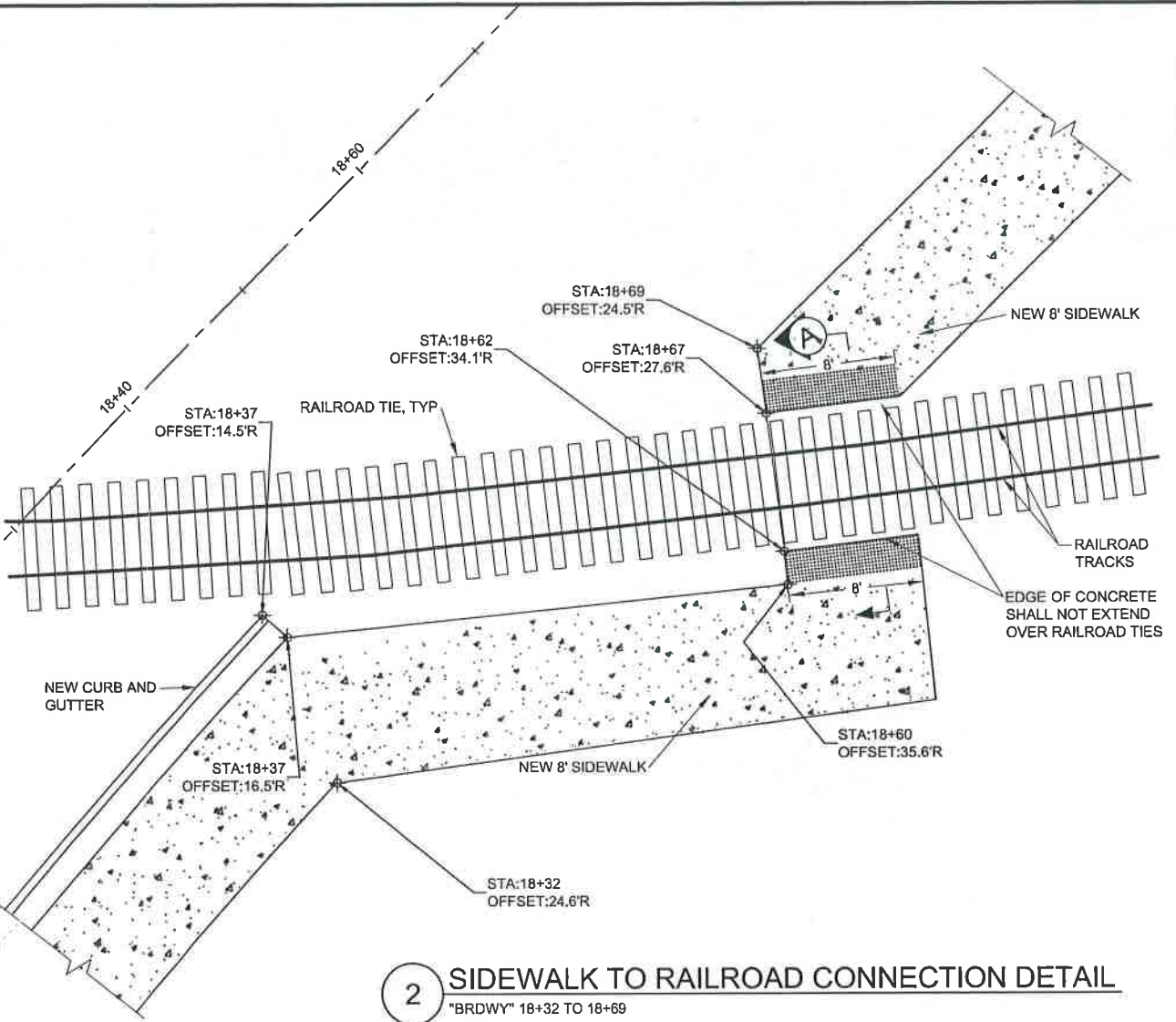

2 SIDEWALK TO RAILROAD CONNECTION DETAIL
 "BRDWY" 18+32 TO 18+69

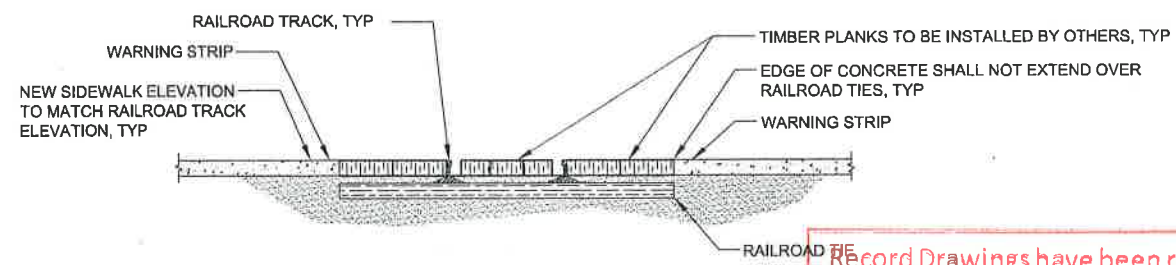

A TYPICAL CROSSING SECTION
 NOTE: SIDEWALK CROSSINGS AT TRACKS MUST BE PERPENDICULAR TO TRACKS.

Record Drawings have been reviewed by the Project Engineer, and represent to the best of my knowledge, the project as constructed.
 PE *K. J. [Signature]* Date 3-23-15

DO NOT SCALE FROM THESE DRAWINGS USE DIMENSIONS

PLAN LEGEND

CHECKED BY: C. TRIPP

DESIGNED BY: T. FAGNANT
 DRAWN BY: T. FAGNANT

STATE OF ALASKA
 DEPARTMENT OF TRANSPORTATION & PUBLIC FACILITIES
 SOUTHEAST REGION
 SKAGWAY PEDESTRIAN IMPROVEMENTS

RAIL CONNECTION DETAILS

PROJECT DESIGNATION	
69304	
STATE	YEAR
ALASKA	2012
SHEET NUMBER	TOTAL SHEETS
J4	21

No.	DATE	DESCRIPTION

Record Drawings have been reviewed
by the Project Engineer, and represent
to the best of my knowledge, the
project as constructed.

PE *[Signature]* Date 3-23-15

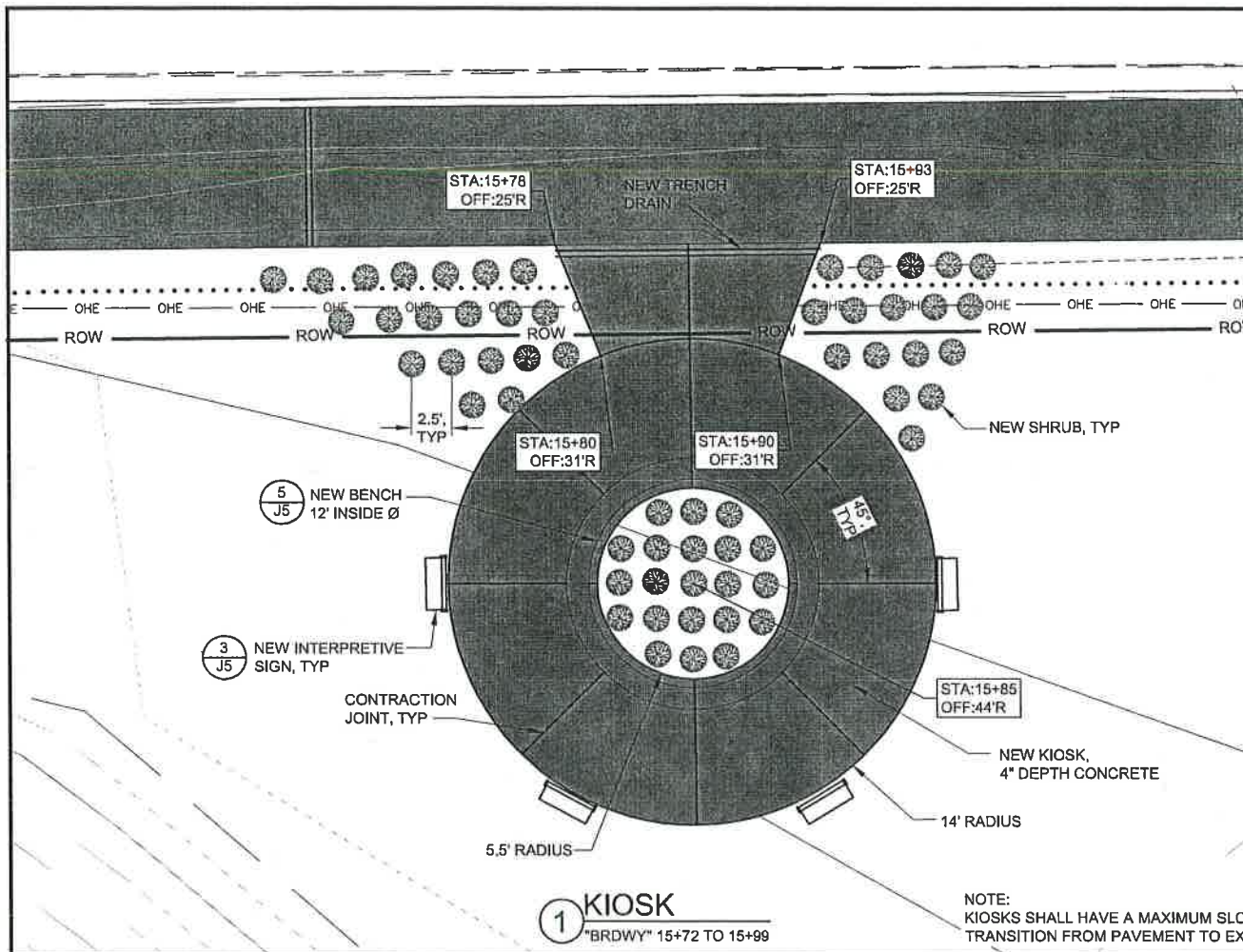

1 KIOSK
"BRDWAY" 15+72 TO 15+99

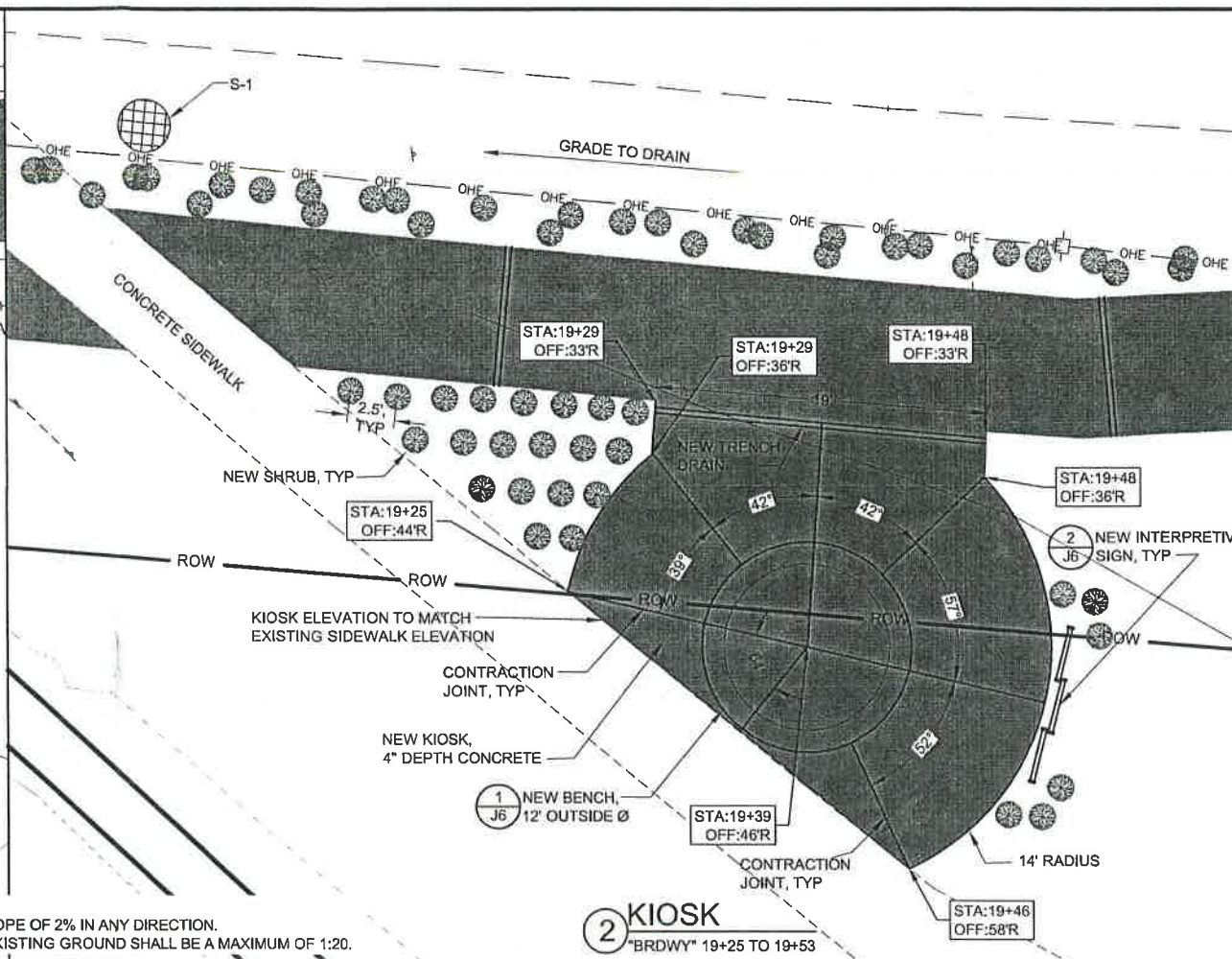

2 KIOSK
"BRDWAY" 19+25 TO 19+53

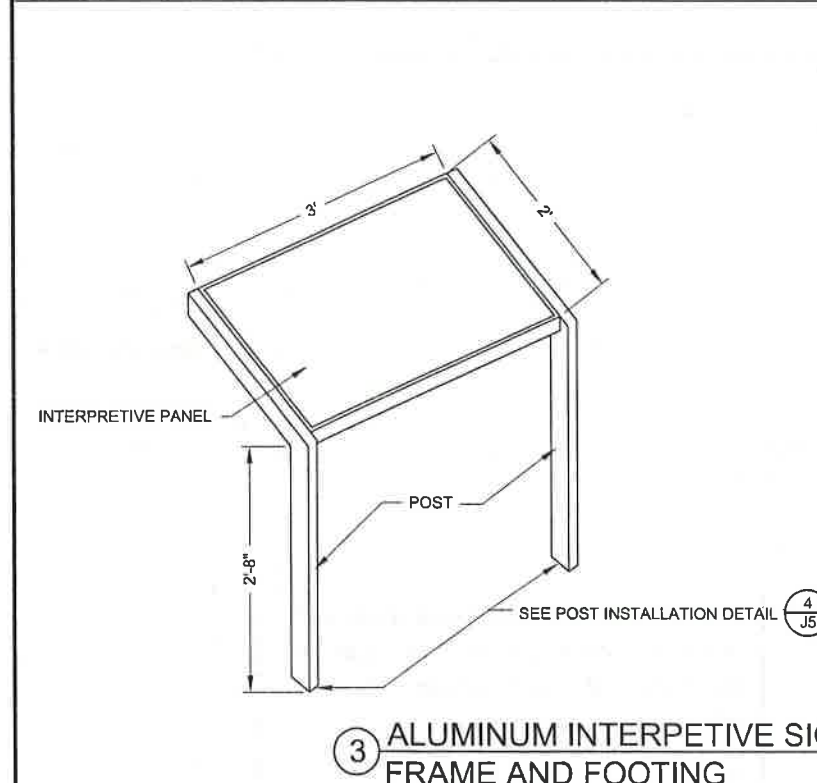

3 ALUMINUM INTERPETIVE SIGN
FRAME AND FOOTING

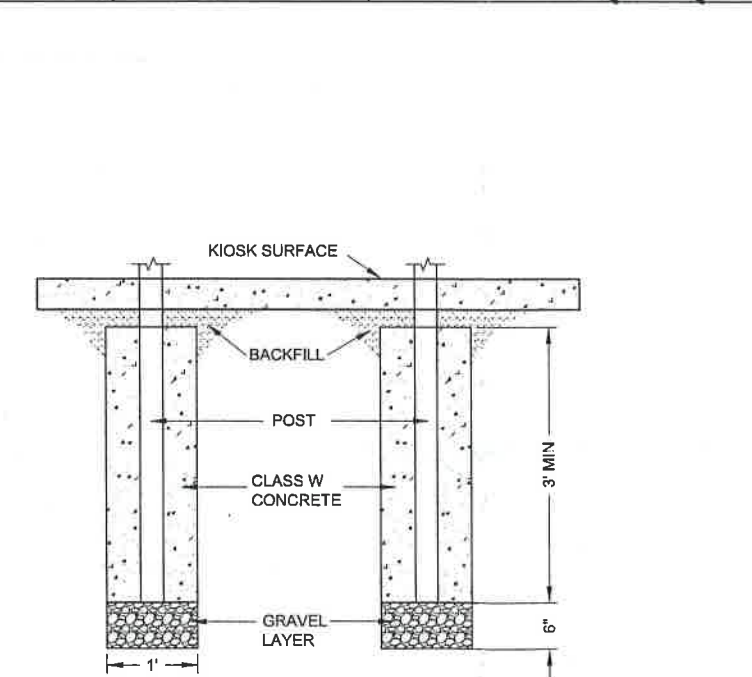

4 POST INSTALLATION - DIRECT EMBEDMENT

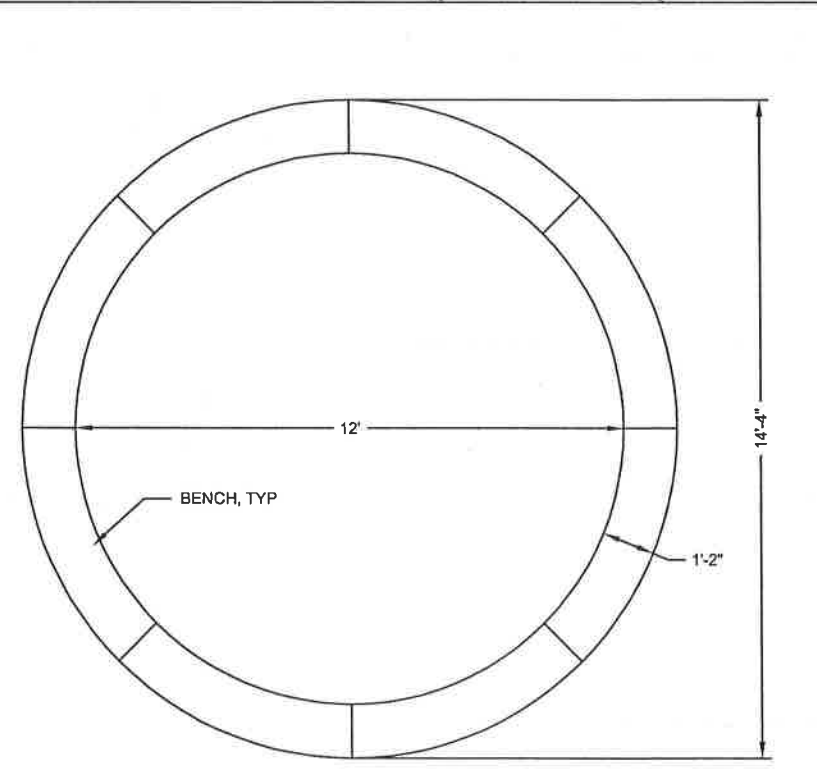

5 12' INSIDE DIAMETER CIRCULAR BENCH

NOTE:
1. INTERPRETIVE PANELS TO BE PROVIDED BY OTHERS.
2. INTERPRETIVE SIGN POSTS SHALL EXTEND AN ADDITIONAL 3.5'
MIN. BELOW SURFACE

PLAN LEGEND

CHECKED BY: C. TRIPP



DESIGNED BY: T. FAGNANT

DRAWN BY: T. FAGNANT

STATE OF ALASKA
DEPARTMENT OF TRANSPORTATION
& PUBLIC FACILITIES
SOUTHEAST REGION

SKAGWAY PEDESTRIAN
IMPROVEMENTS

**MISCELLANEOUS
DETAILS**

PROJECT DESIGNATION

69304

STATE	YEAR
ALASKA	2012
SHEET NUMBER	TOTAL SHEETS
J5	21

DO NOT SCALE FROM THESE DRAWINGS USE DIMENSIONS

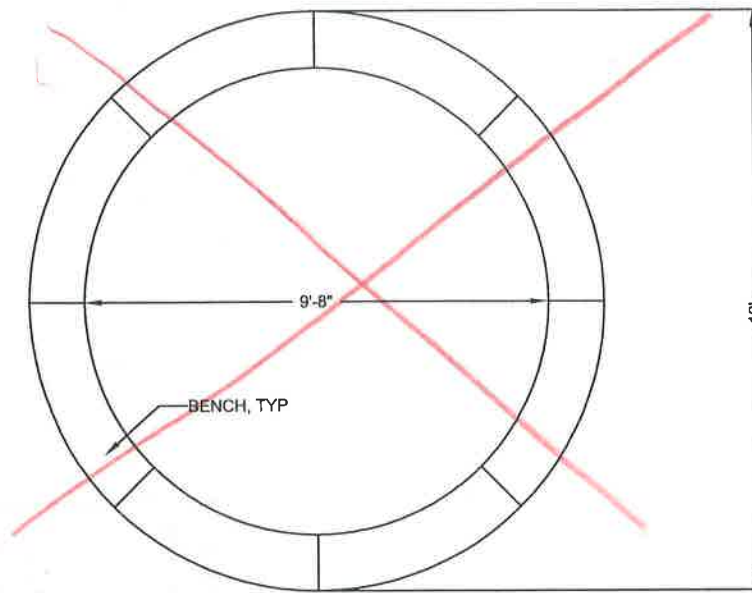

1 12' OUTSIDE DIAMETER CIRCULAR BENCH

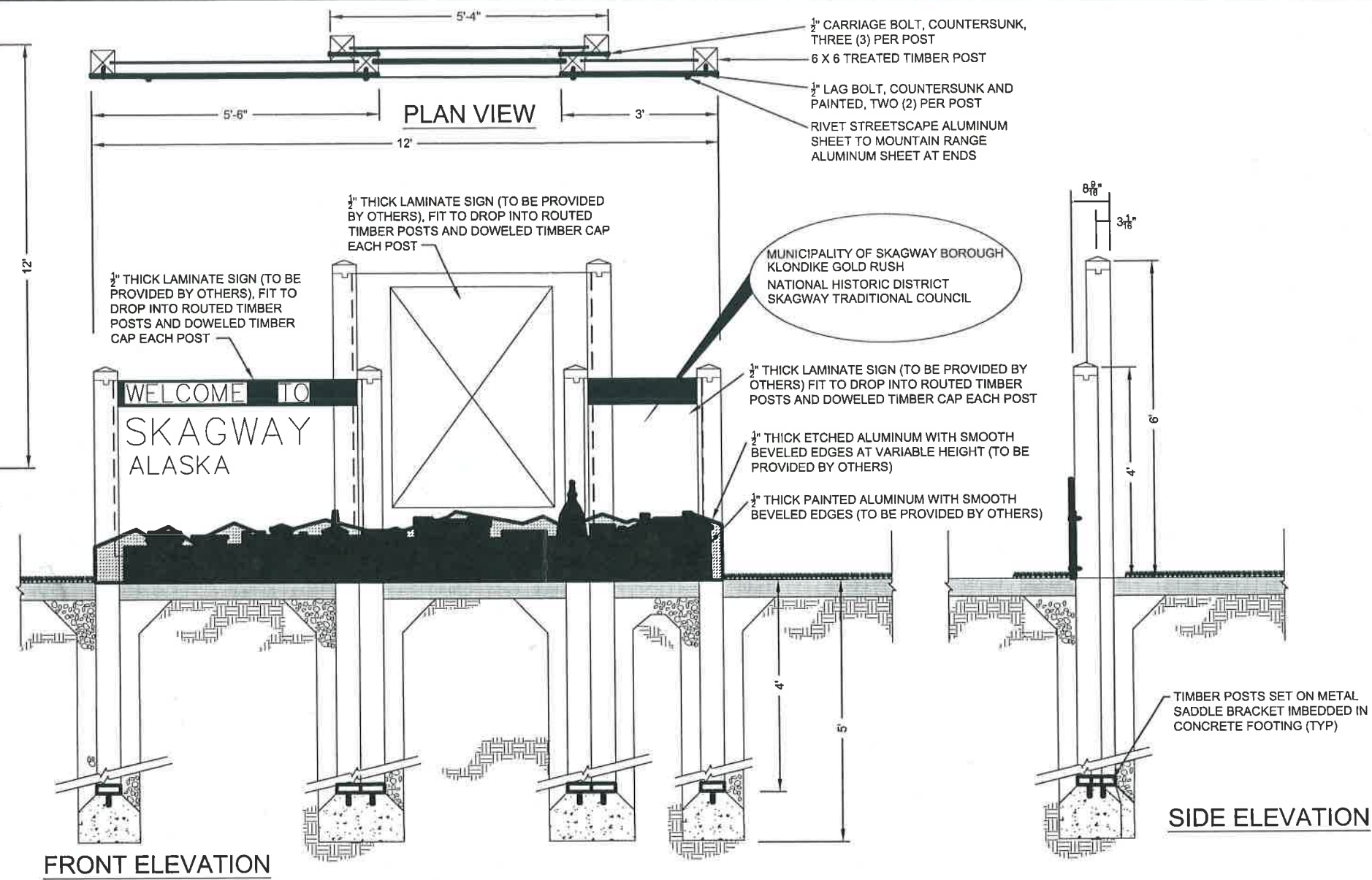

2 WOOD INTERPRETIVE SIGN FRAMES AND FOOTINGS

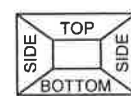

WELD JOINTS PER FRAME CHART
 PANEL WIDTH

PANEL HEIGHT	6	12	18	24	36	48
12	2	0	2	2	2	2
18	2	0	2	2	2	2
24	N/A	2	2	2	2	2
36	N/A	3	3	3	3	N/A
48	N/A	3	3	3	3	N/A

RIVETS PER FRAME CHART
 PANEL WIDTH

PANEL HEIGHT	6	12	18	24	36	48
12	2	2 2	2 3	3 2	2 2	2
18	3	3 3	3 3	3 3	3 3	3
24	N/A	3	3 3	3 3	2 3	3
36	N/A	3	3 3	3 3	3 3	N/A
48	N/A	3	3 3	3 3	3 3	N/A

3 MISCELLANEOUS CHARTS

NUMBERS ARE IN INCHES

Record Drawings have been reviewed by the Project Engineer, and represent to the best of my knowledge, the project as constructed.
 PE *K. P. [Signature]* Date 3-23-15

DO NOT SCALE FROM THESE DRAWINGS USE DIMENSIONS

PLAN LEGEND
 CHECKED BY: C. TRIPP

 DESIGNED BY: T. FAGNANT
 DRAWN BY: T. FAGNANT
 STATE OF ALASKA
 DEPARTMENT OF TRANSPORTATION & PUBLIC FACILITIES
 SOUTHEAST REGION
 SKAGWAY PEDESTRIAN IMPROVEMENTS
 MISCELLANEOUS DETAILS
 PROJECT DESIGNATION
 69304
 STATE ALASKA YEAR 2012
 SHEET NUMBER J6 TOTAL SHEETS 21

No.	DATE	DESCRIPTION

Record Drawings have been reviewed
 by the Project Engineer, and represent
 to the best of my knowledge, the
 project as constructed.
 P.E. *Charles M. Tripp* Date 3-23-15

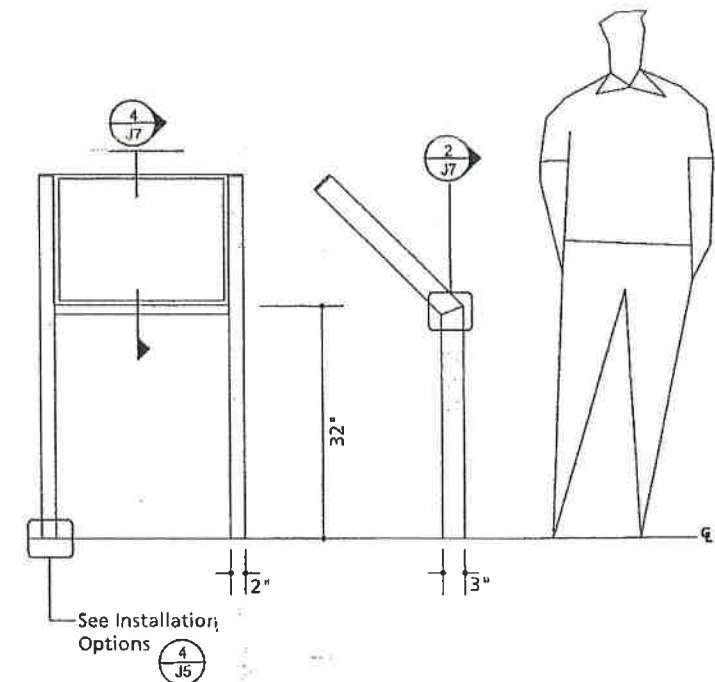

1 LOW PROFILE ELEVATION

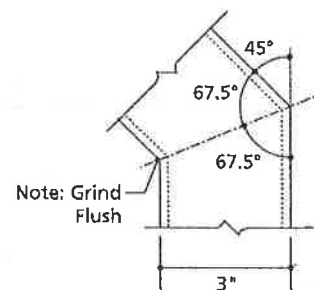

2 POST DETAIL

1/4"-20 x 1/2" Long, 18-8 Stainless Steel, Countersunk Flat Head, Phillips Machine Screw
 Note: Top of Frame is Connected by Screw and is Removable

Post Cap Welded to Top of Post

1/4"-20, 6061-T6 Machine Screw Nut Welded to Aluminum Angle

1/4" Diameter, 5056 Aluminum High Strength, Wide Grip, Dome Style Blind Rivet
 Note: Refer to Rivet Chart for Quantity per Frame

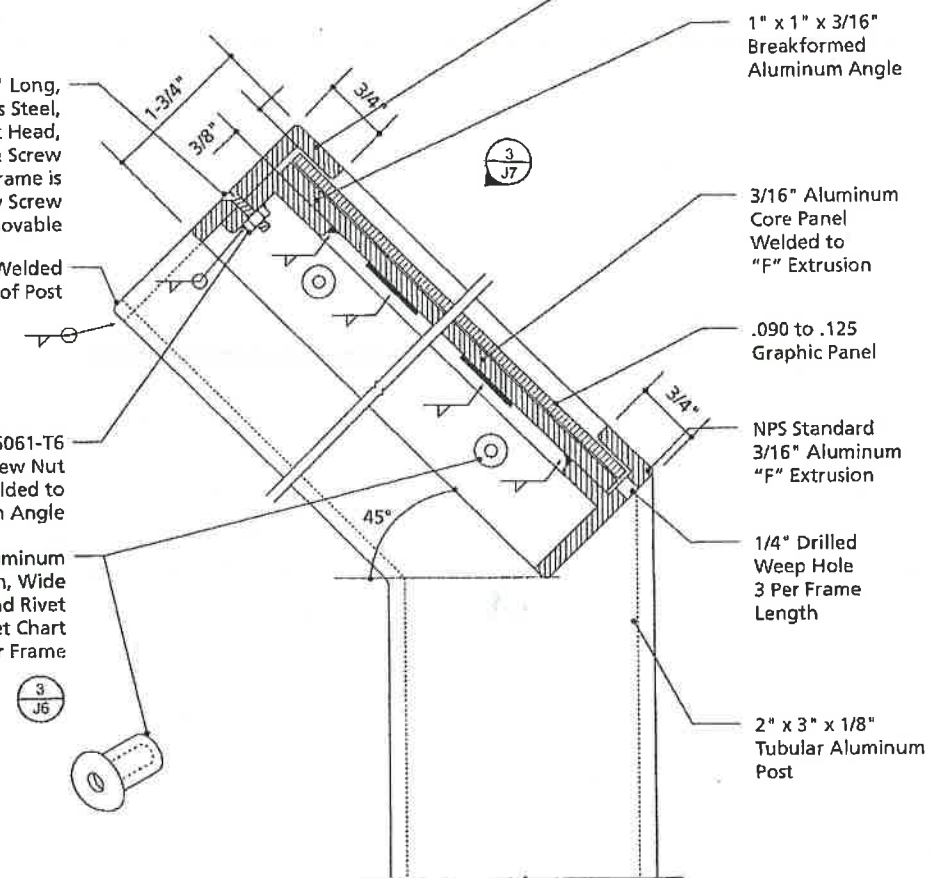

4 SIDE CUT SECTION

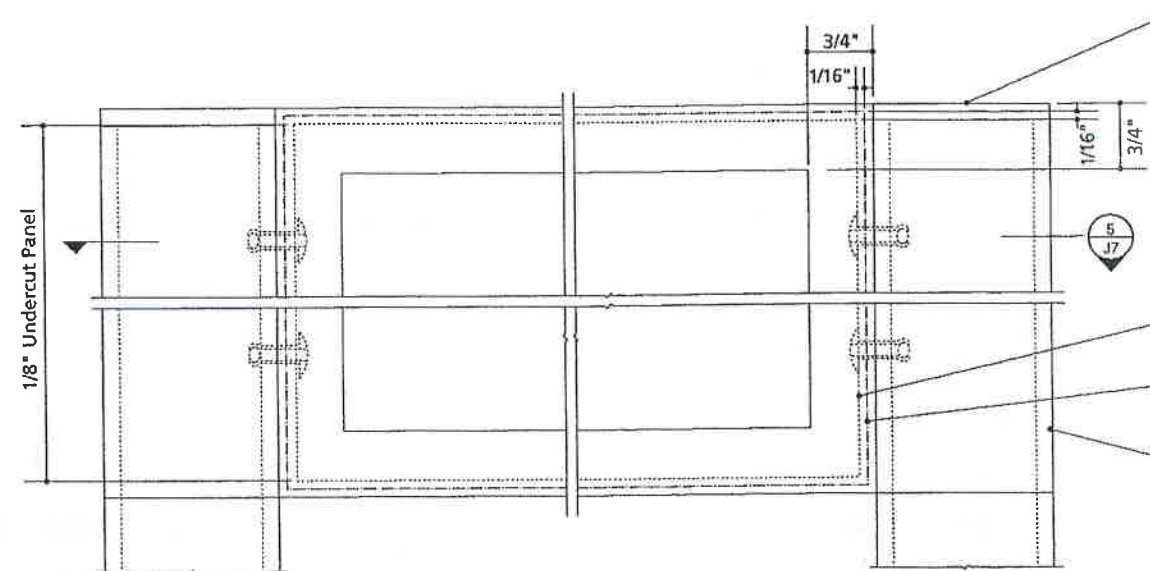

3 FRONT FRAME ELEVATION

Line Of 3/16" Aluminum Frame
 Line Of 1/8" Undercut Graphic Panel
 2" x 3" x 1/8" Tubular Aluminum Posts

Standard NPS 3/16" Aluminum "F" Extrusion

1/4" Diameter, 18-8 5056 Aluminum High Strength, Wide Grip, Dome Style Blind Rivet

2" x 3" x 1/8" Tubular Aluminum Posts

3/16" Aluminum Core Panel Welded to Aluminum Angle

1/16" Gap For Panel Expansion

.090 to .125 Graphic Panel

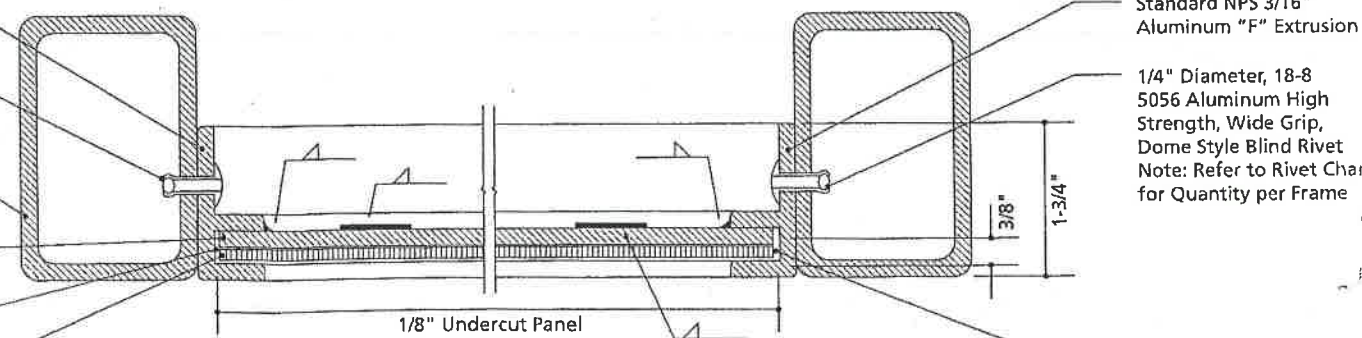

5 FRAME TOP SECTION

Standard NPS 3/16" Aluminum "F" Extrusion

1/4" Diameter, 18-8 5056 Aluminum High Strength, Wide Grip, Dome Style Blind Rivet
 Note: Refer to Rivet Chart for Quantity per Frame

1/16" Gap for Panel Expansion

NOTES

WELDING: ALL WELDS TO BE DONE BY QUALIFIED WELDERS IN ACCORDANCE WITH AWS D1.2. ALL WELDS TO BE DONE WITH 1/4 UNLESS OTHERWISE NOTED.

ALUMINUM: SHAPES - ASTM 6061-T6
 PLATES - ASTM 5068 H112

DO NOT SCALE FROM THESE DRAWINGS USE DIMENSIONS

PLAN LEGEND

CHECKED BY: C. TRIPP



DESIGNED BY: T. FAGNANT

DRAWN BY: T. FAGNANT

STATE OF ALASKA
 DEPARTMENT OF TRANSPORTATION
 & PUBLIC FACILITIES
 SOUTHEAST REGION

SKAGWAY PEDESTRIAN IMPROVEMENTS

INTERPRETIVE SIGN FRAME DETAILS

PROJECT DESIGNATION

69304

STATE ALASKA
 YEAR 2012

SHEET NUMBER TOTAL SHEETS

J7 21

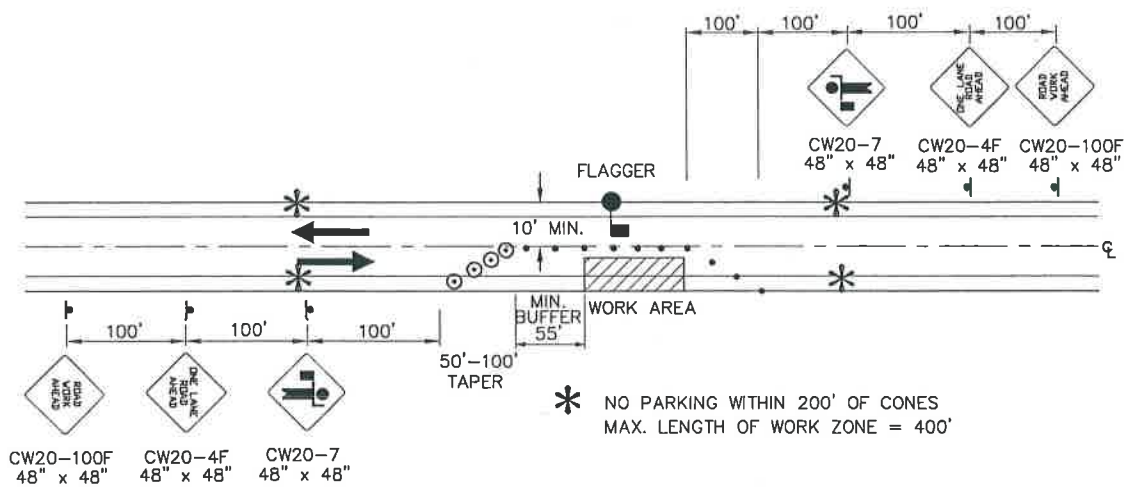

TWO LANE ROAD - SINGLE LANE CLOSURE
SINGLE FLAGGER
 N.T.S.

LEGEND

- SIGN
- CONE
- DRUM
- TYPE III BARRICADE
- FLAGGING STATION

FORMULAS FOR L (TAPER LENGTH)

$$L = \frac{W \times S^2}{60}$$

WHERE W= WIDTH OF OFFSET
 S= POSTED SPEED LIMIT

DRUM OR CONE SPACING = S (IN FEET)

MIN. BUFFER S	LENGTH
20	35
25	55
30	85
35	120
40	170
45	220
50	280
55	335
60	415
65	485

TRAFFIC CONTROL NOTES:

- A MINIMUM OF ONE LANE SHALL BE MAINTAINED AT ALL TIMES, THROUGH ALL WORK AREAS.
- TWO LANES SHALL BE MAINTAINED AT ALL TIMES IN NON-WORK AREAS AND DURING NON-WORK HOURS. UNLESS AN APPROVED TRAFFIC CONTROL SIGNAL HAS BEEN INSTALLED.
- TEMPORARY DRIVING LANES SHALL HAVE A MINIMUM WIDTH OF 10'-0".
- CONSTRUCTION SIGNING SHALL BE IN PLACE ONLY WHEN THE CONDITIONS EXIST FOR WHICH THE SIGNS ARE INTENDED. CONSTRUCTION SIGNS SHALL BE PLACED SUCH THAT THEY DO NOT OBSCURE EXISTING TRAFFIC SIGNS.
- WARNING LIGHTS SHALL BE USED ON ALL CHANNELIZING DEVICES PLACED ALONG OR AROUND ROADWAY HAZARDS AS DIRECTED BY THE ENGINEER.
- IT IS THE INTENT OF THIS TRAFFIC CONTROL PLAN (TCP) TO ILLUSTRATE SOME, NOT ALL, OF THE TRAFFIC CONTROL SETUPS WHICH WILL BE REQUIRED ON THIS PROJECT. PLANS FOR CONFIGURATIONS NOT COVERED BY THE TCP SHALL BE CREATED BY THE CONTRACTOR AND SUBMITTED TO THE ENGINEER FOR APPROVAL. WHERE APPROPRIATE, THEY SHALL INCORPORATE APPLICABLE PORTIONS OF DETAILS ON THESE SHEETS.
- MAXIMUM LENGTH OF CONSTRUCTION WITH ONE-LANE ROAD CLOSURE IS 1000'.

PATH:Q:\ISGY169304\ENIC3D 69304\SOURCE DWG\S1 - TCP.DWG

FAGNANT, THOMAS D (DOT)
 TAB: S1 Wednesday, April 11, 2012 11:32:20

ADDENDUM NUMBER
 ATTACHMENT NUMBER

RECORD OF REVISIONS

No.	DATE	DESCRIPTION

TRAFFIC CONTROL PLAN

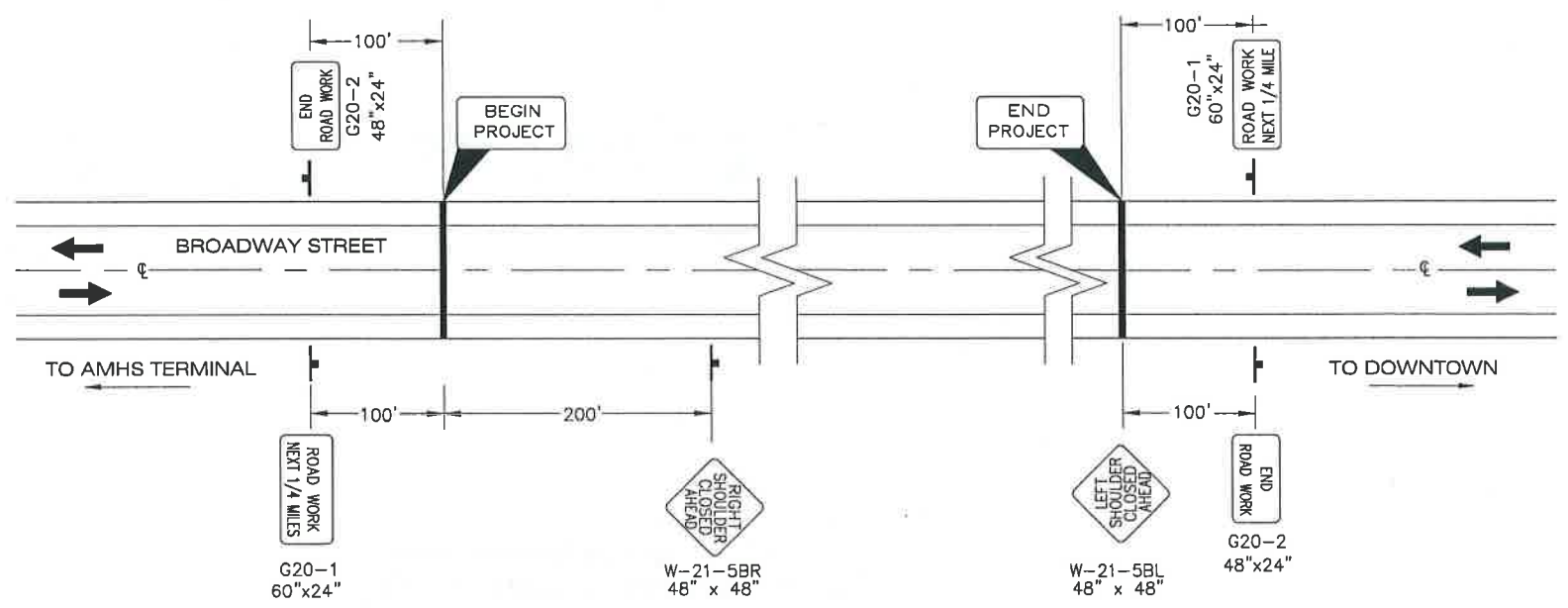

PERMANENT CONSTRUCTION SIGNING
 N.T.S.

NOTE: PLACE AN ADDITIONAL G20-1 SIGN 100' BEFORE INTERSECTION AT STATION 14+00 ON BROADWAY SIDE STREET.

Record Drawings have been reviewed by the Project Engineer, and represent to the best of my knowledge, the project as constructed.
 PE *K.J. Norheim* Date 3-23-15

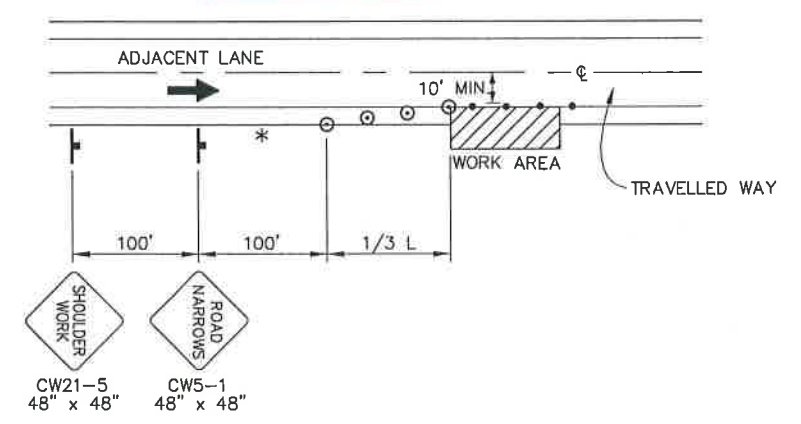

SHOULDER WORK
 N.T.S.

DO NOT SCALE FROM THESE DRAWINGS USE DIMENSIONS

PLAN LEGEND

CHECKED BY: C. TRIPP

DESIGNED BY: T. FAGNANT
 DRAWN BY: T. FAGNANT

STATE OF ALASKA
 DEPARTMENT OF TRANSPORTATION & PUBLIC FACILITIES
 SOUTHEAST REGION
SKAGWAY PEDESTRIAN IMPROVEMENTS

TRAFFIC CONTROL PLAN

PROJECT DESIGNATION

69304

STATE	YEAR
ALASKA	2012
SHEET NUMBER	TOTAL SHEETS
S1	21

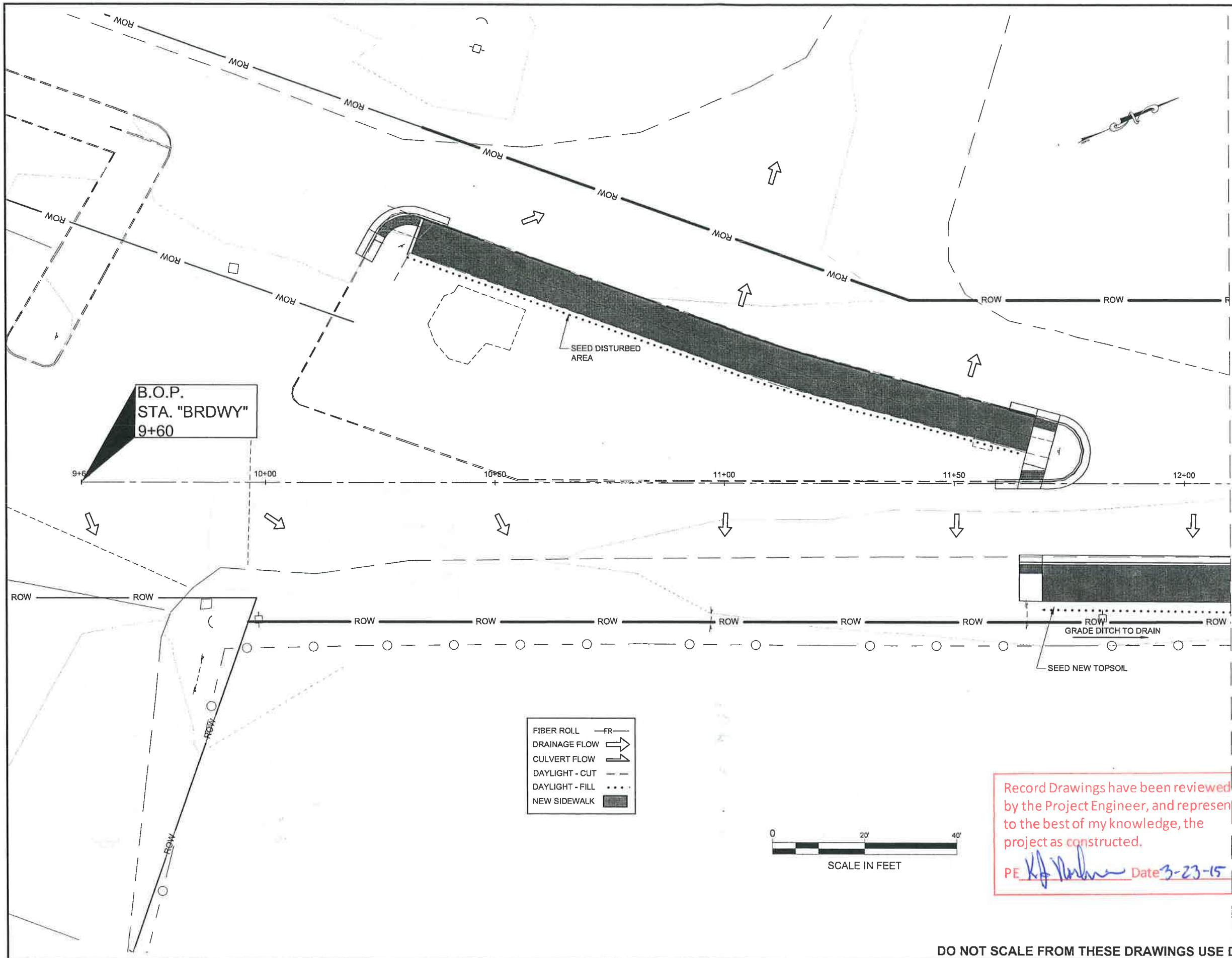

B.O.P.
STA. "BRDWY"
9+60

SEED DISTURBED
AREA

GRADE DITCH TO DRAIN
SEED NEW TOPSOIL

FIBER ROLL	—FR—
DRAINAGE FLOW	→
CULVERT FLOW	→
DAYLIGHT - CUT	- - -
DAYLIGHT - FILL	· · ·
NEW SIDEWALK	■

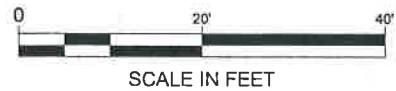

Record Drawings have been reviewed
by the Project Engineer, and represent
to the best of my knowledge, the
project as constructed.

PE *[Signature]* Date 3-23-15

DO NOT SCALE FROM THESE DRAWINGS USE DIMENSIONS

PATH: Q:\SGY\69304\ENIC3D 69304\SOURCE
DWGSIT - ESCP.DWG

FAGNANT, THOMAS D (DOT)
TAB: T1 Wednesday, April 11, 2012 11:38:51 AM

ADDENDUM NUMBER

ATTACHMENT NUMBER

RECORD OF REVISIONS

No.	DATE	DESCRIPTION

EROSION SEDIMENT CONTROL PLAN

PLAN LEGEND

CHECKED BY: C. TRIPP



DESIGNED BY: T. FAGNANT

DRAWN BY: T. FAGNANT

STATE OF ALASKA
DEPARTMENT OF TRANSPORTATION
& PUBLIC FACILITIES
SOUTHEAST REGION

SKAGWAY PEDESTRIAN
IMPROVEMENTS

EROSION SEDIMENT
CONTROL PLAN

PROJECT DESIGNATION	
69304	
STATE	YEAR
ALASKA	2012
SHEET NUMBER	TOTAL SHEETS
T1	21

No.	DATE	DESCRIPTION

EROSION SEDIMENT CONTROL PLAN

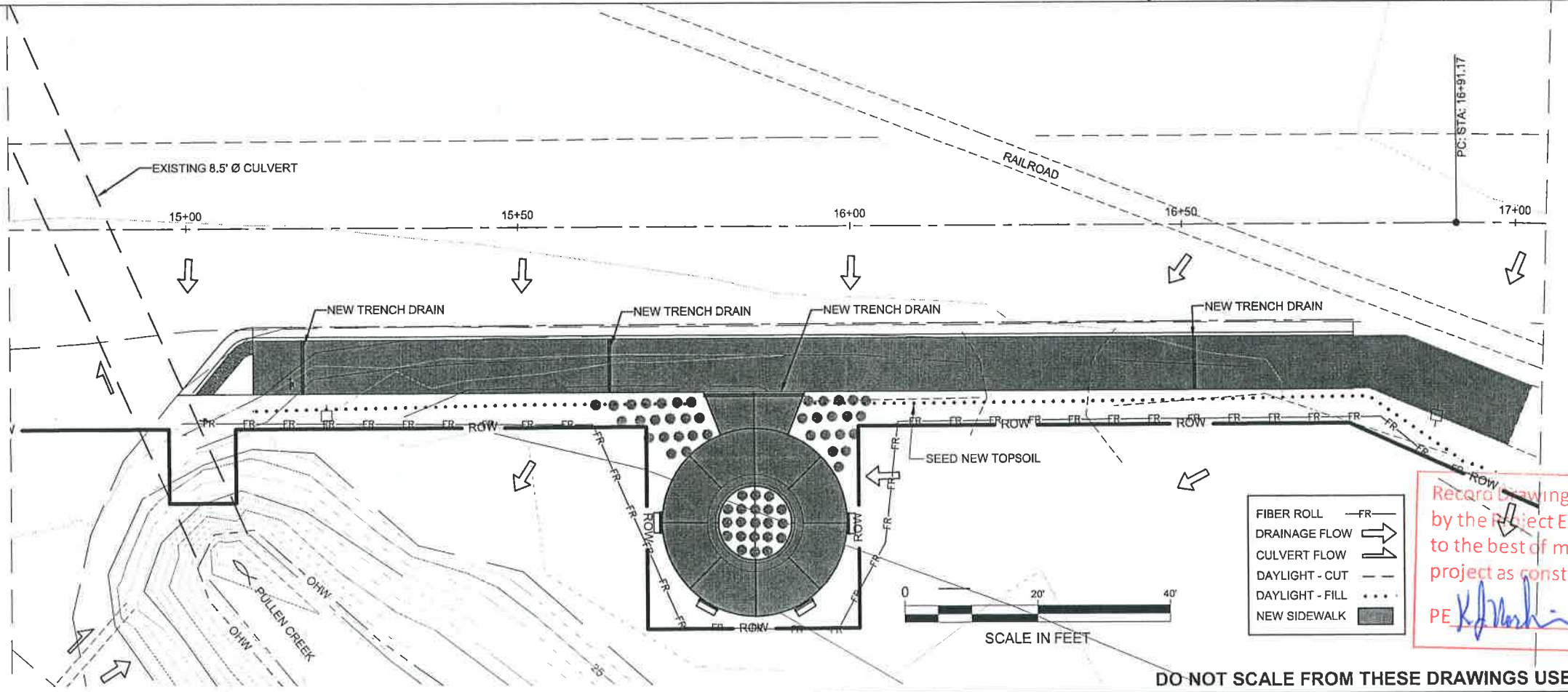
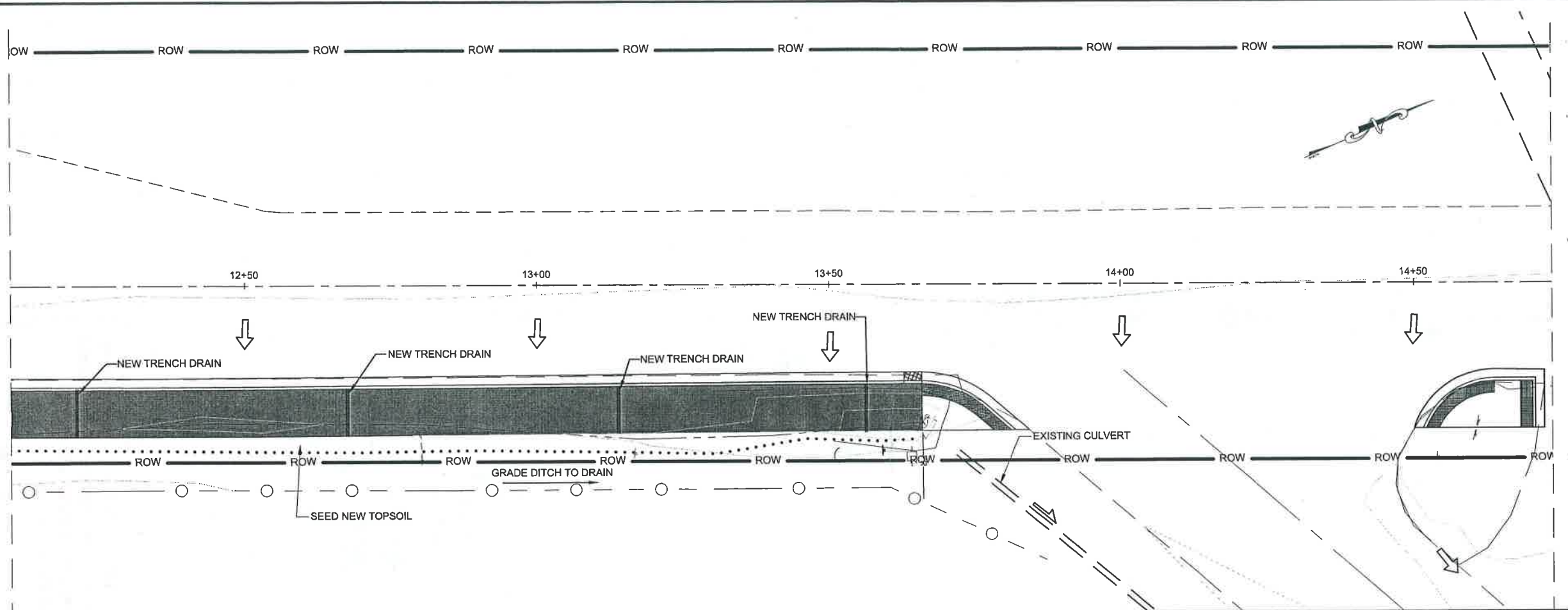

- FIBER ROLL —FR—
- DRAINAGE FLOW →
- CULVERT FLOW ↘
- DAYLIGHT - CUT - - -
- DAYLIGHT - FILL ····
- NEW SIDEWALK [shaded box]

Record Drawings have been reviewed by the Project Engineer, and represent to the best of my knowledge, the project as constructed.
 PE *[Signature]* Date 3-23-12

DO NOT SCALE FROM THESE DRAWINGS USE DIMENSIONS

PLAN LEGEND

CHECKED BY: C. TRIPP



DESIGNED BY: T. FAGNANT

DRAWN BY: T. FAGNANT

STATE OF ALASKA
 DEPARTMENT OF TRANSPORTATION & PUBLIC FACILITIES
 SOUTHEAST REGION

SKAGWAY PEDESTRIAN IMPROVEMENTS

EROSION SEDIMENT CONTROL PLAN

PROJECT DESIGNATION	
69304	
STATE	YEAR
ALASKA	2012
SHEET NUMBER	TOTAL SHEETS
T2	21

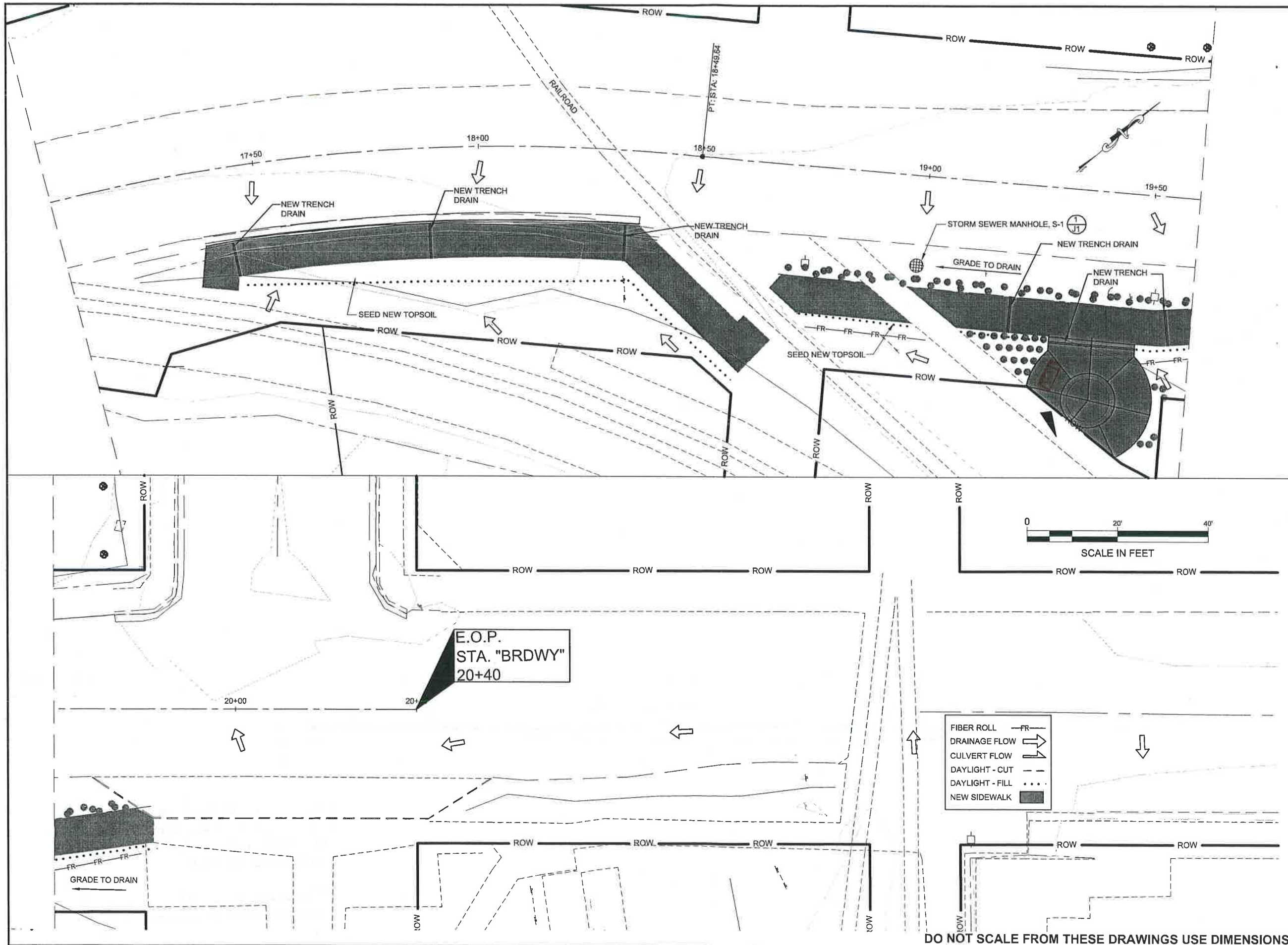

PATH:Q:\ISGY169304\EN\1C3D 69304\SOURCE DWGSET - ESCP.DWG

FAGNANT, THOMAS D (DOT)
 TAB: T3 Wednesday, April 11, 2012 11:37:23 AM

ADDENDUM NUMBER

ATTACHMENT NUMBER

RECORD OF REVISIONS

No.	DATE	DESCRIPTION

Record Drawings have been reviewed by the Project Engineer, and represent to the best of my knowledge, the project as constructed.
 PE *H.J. Mubini* Date 3-23-15

EROSION SEDIMENT CONTROL PLAN

PLAN LEGEND

CHECKED BY: C. TRIPP



DESIGNED BY: T. FAGNANT

DRAWN BY: T. FAGNANT

STATE OF ALASKA
 DEPARTMENT OF TRANSPORTATION
 & PUBLIC FACILITIES
 SOUTHEAST REGION

SKAGWAY PEDESTRIAN
 IMPROVEMENTS

EROSION SEDIMENT CONTROL PLAN

PROJECT DESIGNATION

69304

STATE	YEAR
ALASKA	2012

SHEET NUMBER	TOTAL SHEETS
T3	21

DO NOT SCALE FROM THESE DRAWINGS USE DIMENSIONS

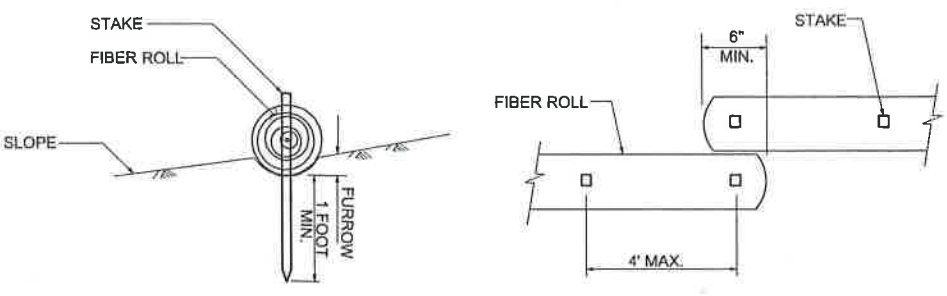

FIBER ROLL (TYPE 1)

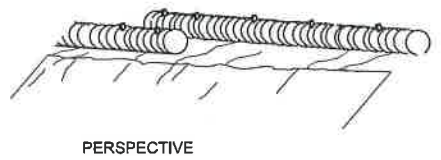

FIBER ROLL (TYPE 1)

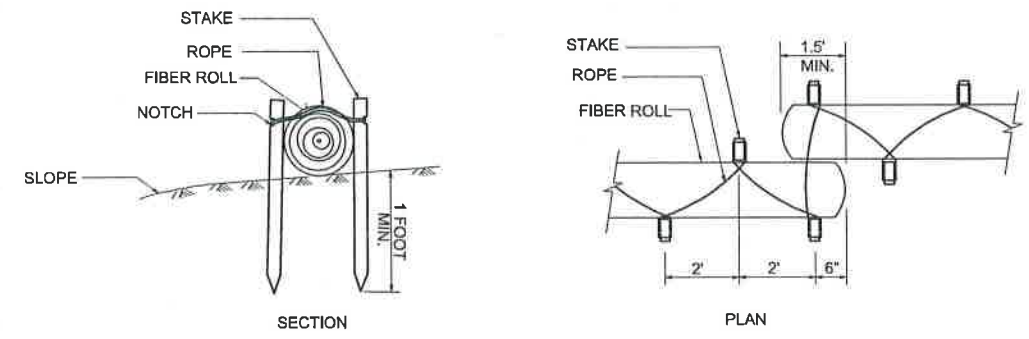

FIBER ROLL (TYPE 2)

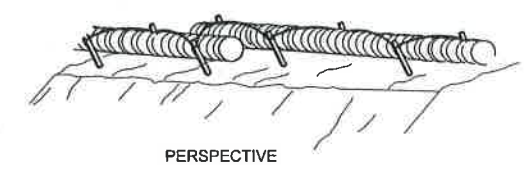

FIBER ROLL (TYPE 2)

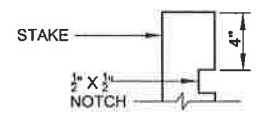

STAKE FOR FIBER ROLL (TYPE 2) NOTCH DETAIL

Record Drawings have been reviewed by the Project Engineer, and represent to the best of my knowledge, the project as constructed.
 PE *K. J. Nash* Date 3-23-15

DO NOT SCALE FROM THESE DRAWINGS USE DIMENSIONS

EROSION SEDIMENT CONTROL PLAN DETAILS

PLAN LEGEND

CHECKED BY: C. TRIPP



DESIGNED BY: T. FAGNANT
 DRAWN BY: T. FAGNANT

STATE OF ALASKA
 DEPARTMENT OF TRANSPORTATION
 & PUBLIC FACILITIES
 SOUTHEAST REGION
 SKAGWAY PEDESTRIAN
 IMPROVEMENTS

EROSION SEDIMENT CONTROL PLAN DETAILS

PROJECT DESIGNATION	
69304	
STATE	YEAR
ALASKA	2012
SHEET NUMBER	TOTAL SHEETS
T4	21

SKAGWAY